

PLOTTED: 4-OCT-2023 10:06

OPERATOR: Zachary Kaczmarek
FILE NAME: pw://kci-pw.bentley.com/kci-pw-05/Documents/Projects/2023/222302374-02/Worksets/dgm/R/W/254108B00_RTOW_PLAN_01.dgn

EXISTING STRUCTURE DATA (SR 4108)

T608 STA 20+00.00
TYPE = 4 SPAN PRESTRESSED CONCRETE
ADJACENT BOX BEAM BRIDGE
SPAN LENGTHS = 48'-0", 86'-3",
86'-3", 39'-0"
SKEW = 47°48'20"
CLEAR ROADWAY = 28'-0"

PROPOSED STRUCTURE DATA (SR 4108)

T608 STA 20+00.00
TYPE = 2 SPAN PRESTRESSED CONCRETE
BOX BEAM BRIDGE
SPAN LENGTHS = 100'-0"
SKEW = 47°48'20"
CLEAR ROADWAY = 28'-0"

DISTRICT	COUNTY	ROUTE	SECTION	SHEET
1-0	ERIE	4108	800 R/W	5 OF 7
HARBORCREEK TOWNSHIP				
REV NO	REVISIONS	DATE	BY	APPD

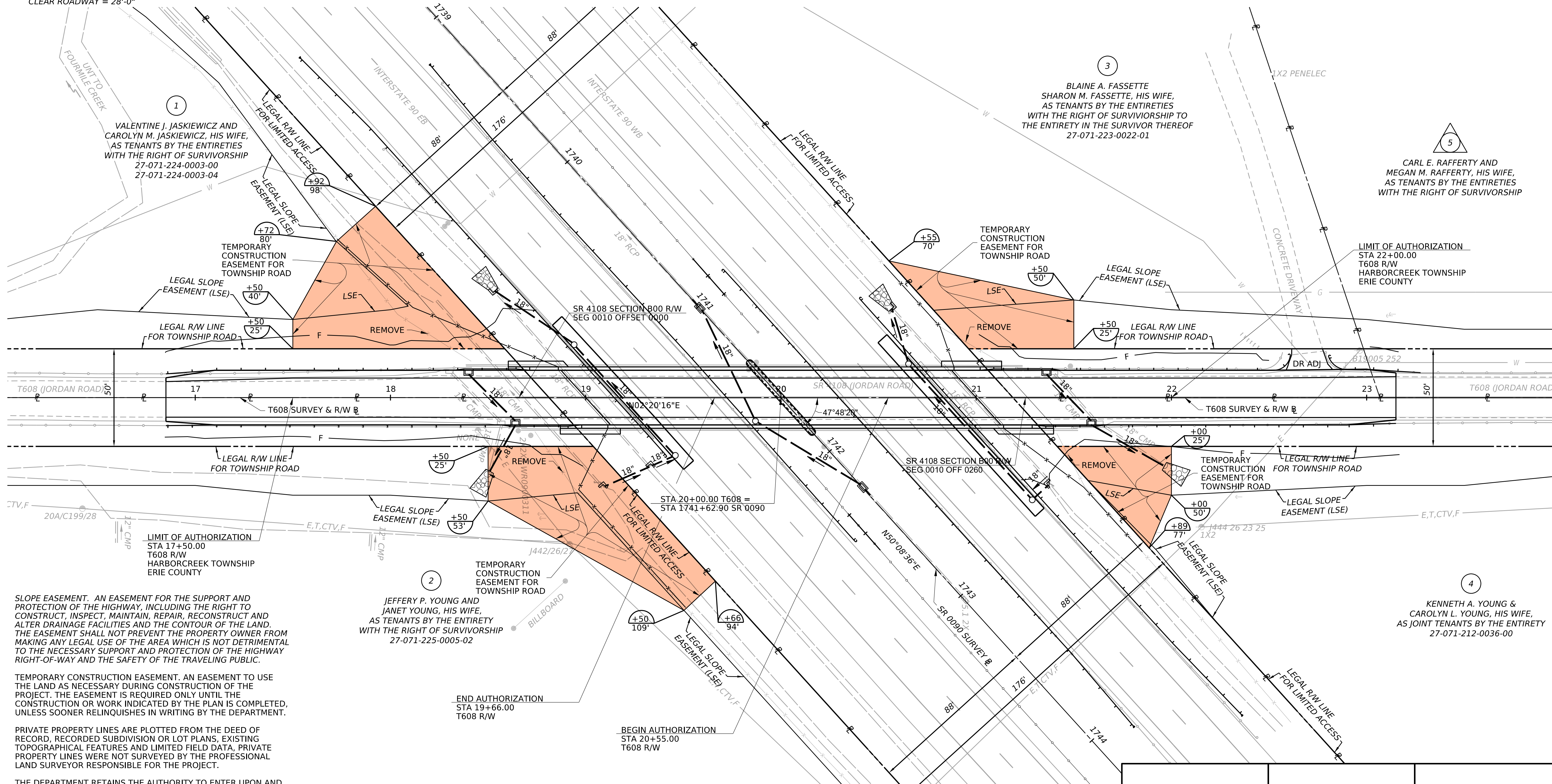

SLOPE EASEMENT. AN EASEMENT FOR THE SUPPORT AND PROTECTION OF THE HIGHWAY, INCLUDING THE RIGHT TO CONSTRUCT, INSPECT, MAINTAIN, REPAIR, RECONSTRUCT AND ALTER DRAINAGE FACILITIES AND THE CONTOUR OF THE LAND. THE EASEMENT SHALL NOT PREVENT THE PROPERTY OWNER FROM MAKING ANY LEGAL USE OF THE AREA WHICH IS NOT DETRIMENTAL TO THE NECESSARY SUPPORT AND PROTECTION OF THE HIGHWAY RIGHT-OF-WAY AND THE SAFETY OF THE TRAVELING PUBLIC.

TEMPORARY CONSTRUCTION EASEMENT. AN EASEMENT TO USE THE LAND AS NECESSARY DURING CONSTRUCTION OF THE PROJECT. THE EASEMENT IS REQUIRED ONLY UNTIL THE CONSTRUCTION OR WORK INDICATED BY THE PLAN IS COMPLETED, UNLESS SOONER RELINQUISHES IN WRITING BY THE DEPARTMENT.

PRIVATE PROPERTY LINES ARE PLOTTED FROM THE DEED OF RECORD, RECORDED SUBDIVISION OR LOT PLANS, EXISTING TOPOGRAPHICAL FEATURES AND LIMITED FIELD DATA, PRIVATE PROPERTY LINES WERE NOT SURVEYED BY THE PROFESSIONAL LAND SURVEYOR RESPONSIBLE FOR THE PROJECT.

LEGEND

- PARCEL IDENTIFICATION NUMBER
- TEMPORARY CONSTRUCTION EASEMENT
- PARCEL IDENTIFICATION NUMBER - NO TAKE

THIS PLAN IS NOT TO BE SUBSTITUTED FOR A BOUNDARY SURVEY.

**PRELIMINARY
NOT FOR
CONSTRUCTION**

SURVEY BOOK NO. 20646
FOR PROFILE SEE SHEET 6

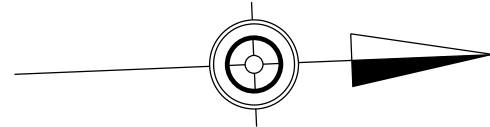

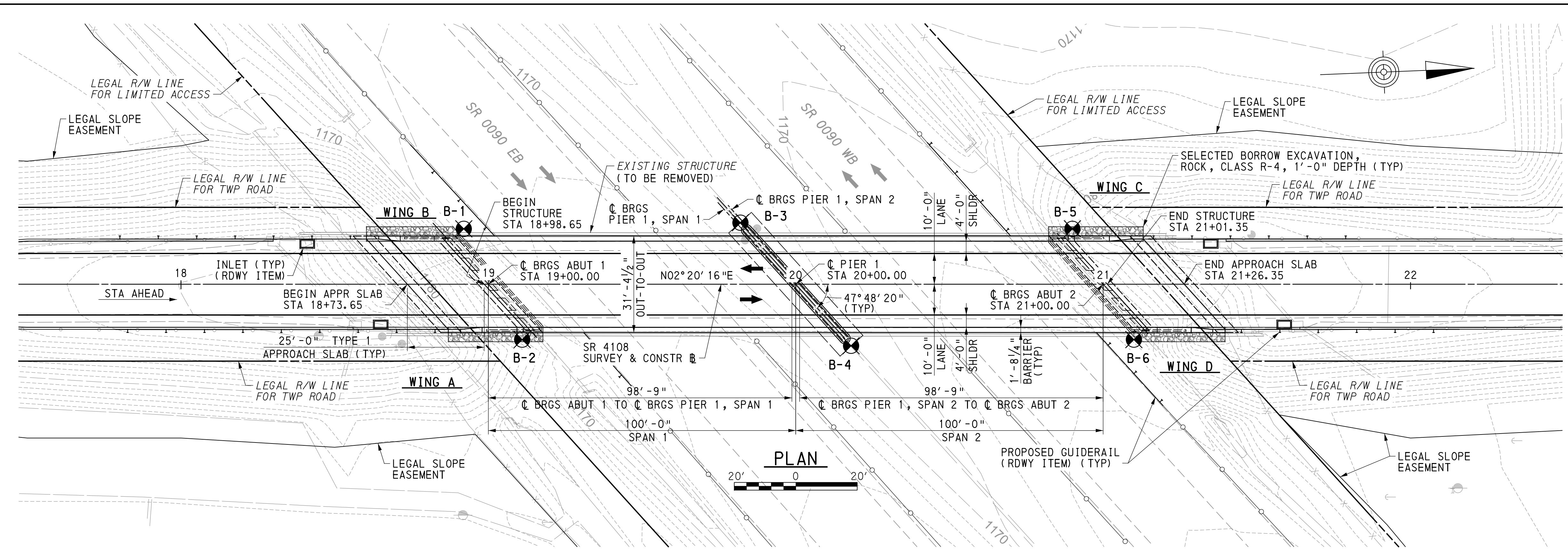

SR 4108
VERTICAL ALIGNMENT DATA
 PVI STA 20+00.00
 PVI ELEV = 1201.43
 VC = 580.00'
 MO = -7.59'
 SSD = 346'
 +5.00% @ -5.48%

SR 4108
HORIZONTAL ALIGNMENT DATA
 TANGENT AT N 02° 20' 16" E
EXISTING STRUCTURE DATA
 STA 20+00.00
 TYPE = 4 SPAN PRESTRESSED CONCRETE
 ADJACENT BOX BEAM BRIDGE
 SPAN LENGTHS = 48'-0", 86'-3",
 86'-3", 39'-0"
 SKEW = 47°48'20"
 CLEAR ROADWAY = 28'-0"

PROPOSED BORING LOCATIONS

BORING	STATION	OFFSET
B-1	18+92.00	18.00' L
B-2	19+11.00	18.00' R
B-3	19+82.00	20.00' L
B-4	20+18.00	20.00' R
B-5	20+90.00	18.00' L
B-6	21+10.00	18.00' R

WINGWALL LENGTHS

WING	LENGTH
A	18'-0"
B	18'-6"
C	17'-6"
D	18'-0"

- LEGEND**
- PROPOSED BORING LOCATION
 - TRAFFIC DIRECTION
 - PROPOSED CONTOURS
 - EXISTING CONTOURS
 - EXISTING UTILITY POLE/SIGN

NOTES
 1. FOR GENERAL NOTES AND TYPICAL SECTION, SEE SHEET 2.

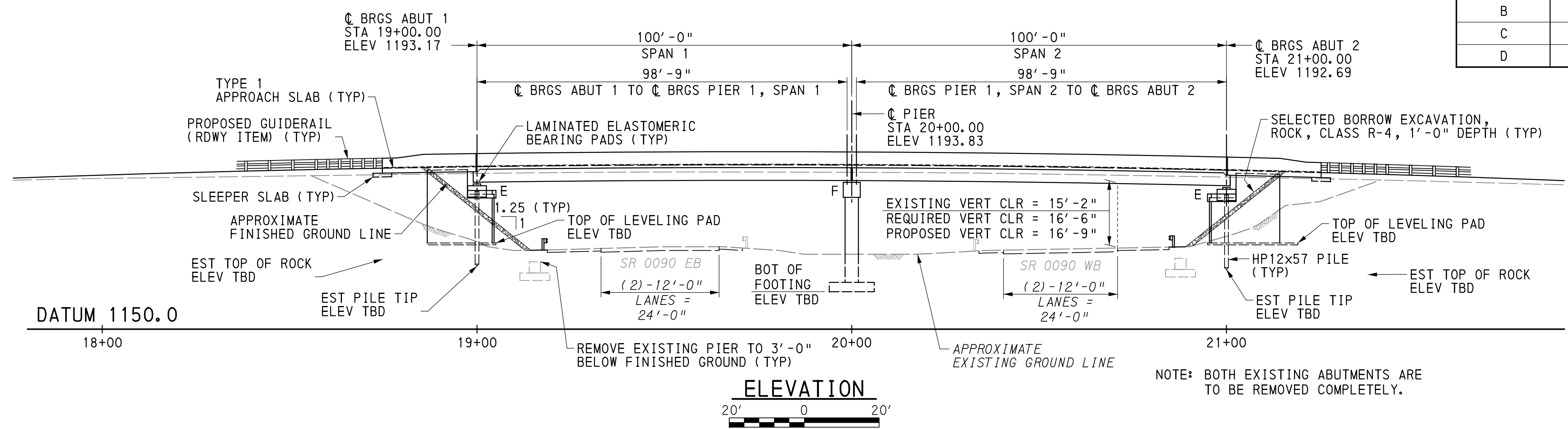

Mark	Description	By	Chk'd.	Recm'd.	Date
REVISIONS					

BMS STR ID: 25-4108-0010-0000 MPMS PROJ: 47501 BRKEY: PENDING

COMMONWEALTH OF PENNSYLVANIA
DEPARTMENT OF TRANSPORTATION

ERIE COUNTY
SR 4108 SECTION B00
 SEGMENT 0010 OFFSET 0000
 SR 4108-B00 STA 20+00.00 OVER SR 0090
2-SPAN COMP P/S CONC SPR BOX BEAM BRIDGE
TYPE, SIZE & LOCATION - 1

RECOMMENDED _____ SHEET 1 OF 2
S-41708

PRELIMINARY
NOT FOR CONSTRUCTION

PREPARED BY :

KCI TECHNOLOGIES, INC
 500 CHERRINGTON PARKWAY
 SUITE 210
 MOON TOWNSHIP, PA 15108
 TEL: (412) 824-7046

06-06-2023
 DATE

PROFESSIONAL ENGINEER _____

GENERAL NOTES

GENERAL

PROVIDE MATERIALS AND PERFORM WORK IN ACCORDANCE WITH SPECIFICATIONS, PUBLICATION 408/2020, AASHTO/AWS D1.5M/D1.5 2015 BRIDGE WELDING CODE AND CONTRACT SPECIAL PROVISIONS.

USE AASHTO/AWS D1.1/D1.1M:2008 FOR WELDING NOT COVERED IN AASHTO/AWS D1.5M/D1.5:2015.

DESIGN SPECIFICATIONS

AASHTO LRFD BRIDGE DESIGN SPECIFICATIONS, 8TH EDITION, 2017, AND AS SUPPLEMENTED BY DESIGN MANUAL, PART 4, DECEMBER 2019 EDITION.

LIVE LOAD DISTRIBUTION TO GIRDERS IS BASED UPON DM-4 DISTRIBUTION FACTORS.

DESIGN IS IN ACCORDANCE WITH THE LRFD METHOD.

DESIGN LIVE LOADS

PHL-93, P-82 AND P2016-13.

FATIGUE IS BASED ON THE FOLLOWING:

PRESTRESSED CONCRETE: ADTT 82 (2045), (ONE-DIRECTIONAL)

MAXIMUM ALLOWABLE TENSILE STRESS IN PRECOMPRESSED TENSILE ZONE: $0.0948 \sqrt{f'c}$

DEAD LOADS

INCLUDES A SURFACE AREA DENSITY OF 0.030 KSF FOR FUTURE WEARING SURFACE ON THE DECK SLAB.

INCLUDES A SURFACE AREA DENSITY OF 0.015 KSF FOR PERMANENT METAL DECK FORMS WHICH TAKES INTO ACCOUNT THE WEIGHT OF THE FORM, PLUS THE WEIGHT OF THE CONCRETE IN THE VALLEYS OF THE FORMS.

INCLUDES 200 LBS PER SQUARE YARD OF POLYESTER POLYMER CONCRETE (PPC) OVERLAY.

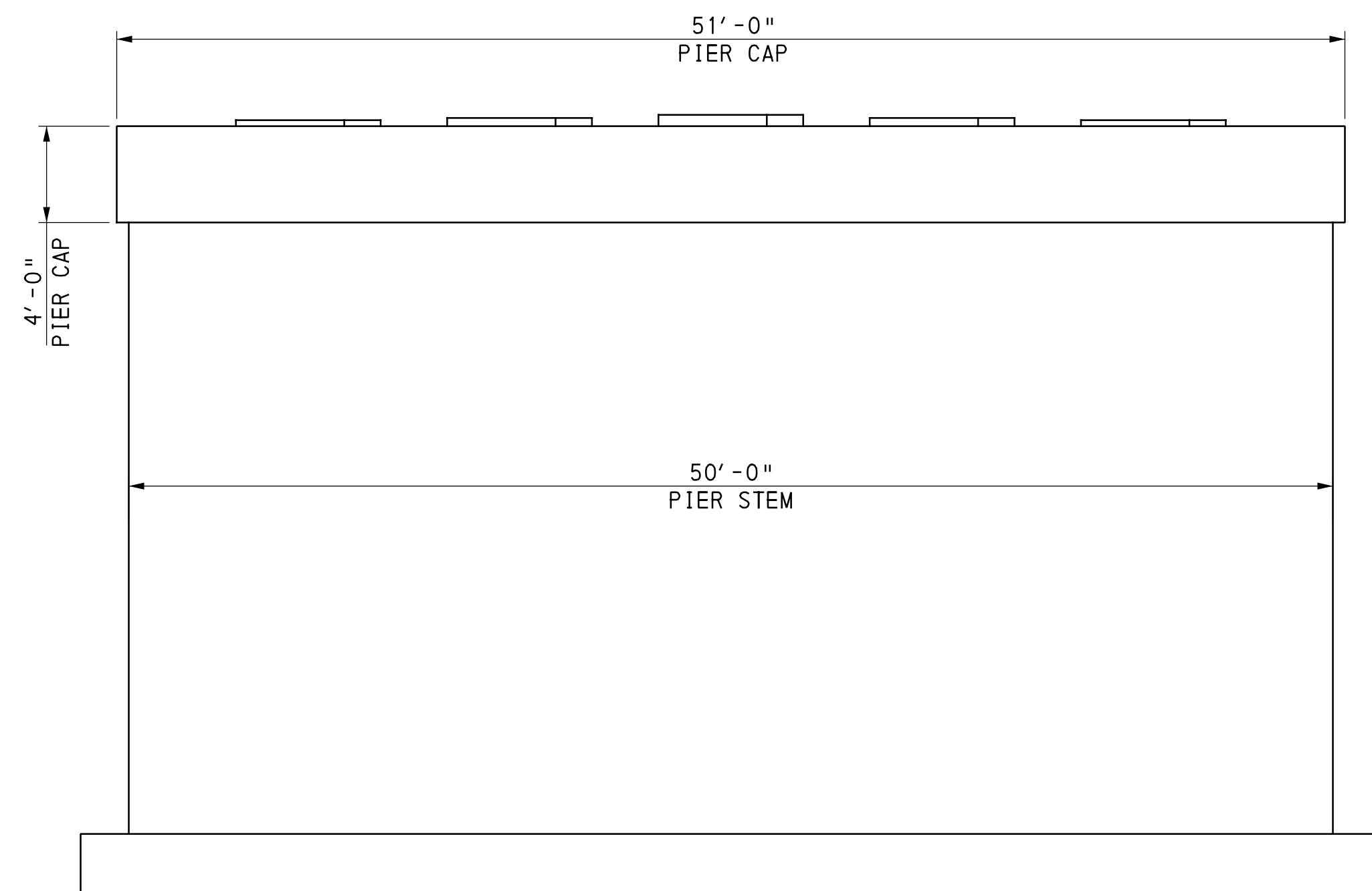
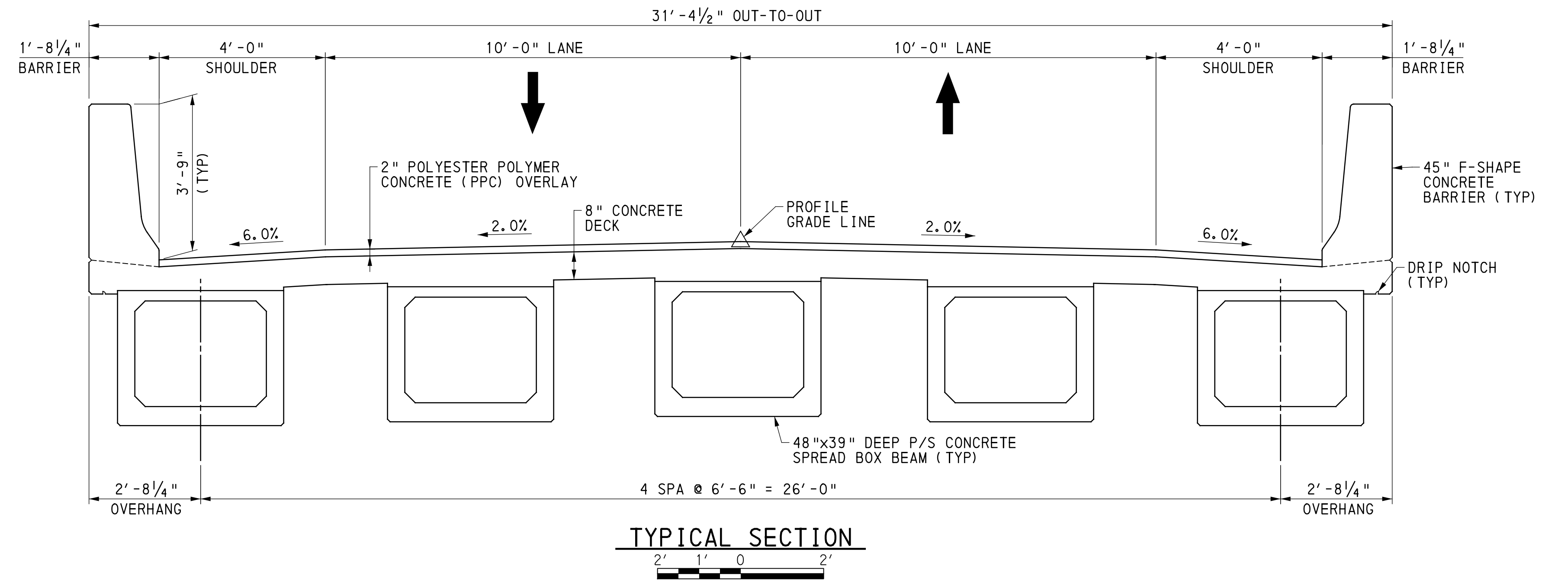

PIER ELEVATION

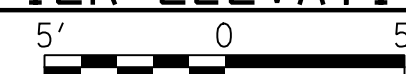

Mark	Description	By	Chk' d.	Recm' d.	Date
REVISIONS					

BMS STR ID: 25-4108-0010-0000 MPMS PROJ: 47501 BRKEY: PENDING

COMMONWEALTH OF PENNSYLVANIA
DEPARTMENT OF TRANSPORTATION

ERIE COUNTY
SR 4108 SECTION B00
SEGMENT 0010 OFFSET 0000
SR 4108-B00 STA 20+00.00 OVER SR 0090
2-SPAN COMP P/S CONC SPR BOX BEAM BRIDGE
GENERAL NOTES & TYPICAL SECTION

PRELIMINARY
NOT FOR
CONSTRUCTION

PREPARED BY
KCI TECHNOLOGIES

RECOMMENDED _____

SHEET 2 OF 2

S-41708