

PLOTTED: 16-JAN-2024 12:04

OPERATOR: Patrick.Smith
FILE NAME: pw://mb-us-pw.bentley.com:mb-us-pw-01/Documents/MoonTownship_PA/01_Projects/SR_0318_Emergency_Bridge_Replacement/deliverables/plots/plan/430318B07_Plan.dgn

DES: PSS | DWG: WRB | CKD: CAB

DISTRICT	COUNTY	ROUTE	SECTION	SHEET
1-0	MERCER	0318	B07	3 OF 5
SHENANGO TOWNSHIP				
REV NO	REVISIONS			DATE BY APPD

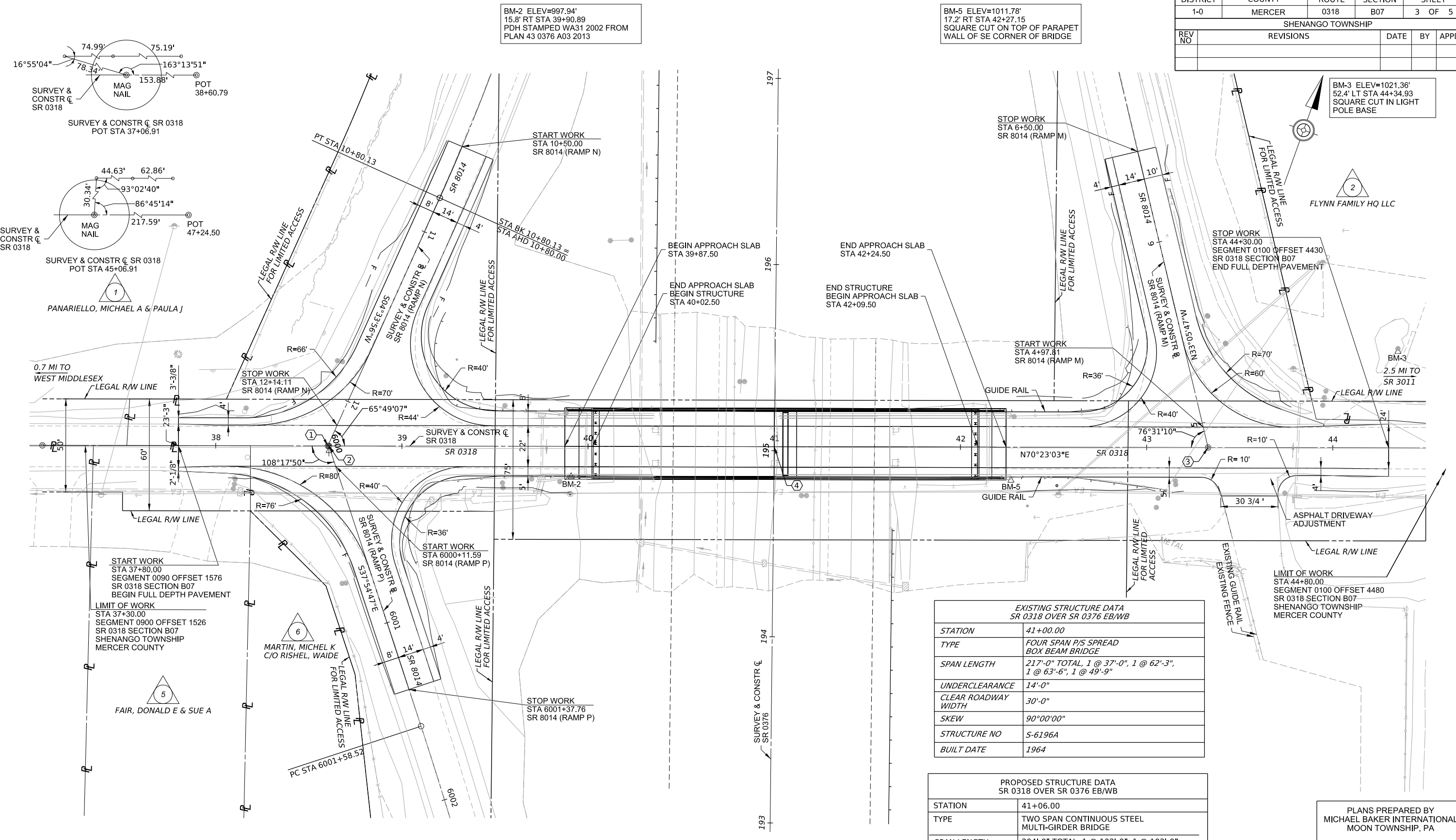

BM-2 ELEV=997.94'
15.8' RT STA 39+90.89
PDH STAMPED WA31 2002 FROM
PLAN 43 0376 A03 2013

BM-5 ELEV=1011.78'
17.2' RT STA 42+27.15
SQUARE CUT ON TOP OF PARAPET
WALL OF SE CORNER OF BRIDGE

BM-3 ELEV=1021.36'
52.4' LT STA 44+34.93
SQUARE CUT IN LIGHT
POLE BASE

EXISTING STRUCTURE DATA SR 0318 OVER SR 0376 EB/WB	
STATION	41+00.00
TYPE	FOUR SPAN P/S SPREAD BOX BEAM BRIDGE
SPAN LENGTH	217'-0" TOTAL, 1 @ 37'-0", 1 @ 62'-3", 1 @ 63'-6", 1 @ 49'-9"
UNDERCLEARANCE	14'-0"
CLEAR ROADWAY WIDTH	30'-0"
SKEW	90°00'00"
STRUCTURE NO	S-6196A
BUILT DATE	1964

PROPOSED STRUCTURE DATA SR 0318 OVER SR 0376 EB/WB	
STATION	41+06.00
TYPE	TWO SPAN CONTINUOUS STEEL MULTI-GIRDER BRIDGE
SPAN LENGTH	204'-0" TOTAL, 1 @ 102'-0", 1 @ 102'-0"
UNDERCLEARANCE	16'-11"
ROADWAY WIDTH	35'-0"
SKEW	90°00'00"
STRUCTURE NO	S-42178

- ① POT STA 38+60.24 SR 0318 SURVEY AND CONSTR C=
- POT STA 12+26.12 SR 8014 (RAMP N) SURVEY AND CONSTR C=
- ② POT STA 38+60.79 SR 0318 SURVEY AND CONSTR C=
- POT STA 6000+00.00 SR 8014 (RAMP P) SURVEY AND CONSTR C=
- ③ POT STA 43+32.80 SR 0318 SURVEY AND CONSTR C=
- POT STA 4+87.44 SR 8014 (RAMP M) SURVEY AND CONSTR C=
- ④ POT STA 41+00.00 SR 0318 SURVEY AND CONSTR C=
- POT STA 195+02.13 SR 0376 SURVEY AND CONSTR C=

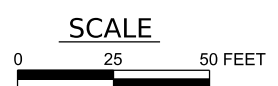

SURVEY BOOK # 20689
FOR SR 0318 PROFILE, SEE SHEET 4
FOR RAMP PROFILES, SEE SHEET 5

PLANS PREPARED BY
MICHAEL BAKER INTERNATIONAL
MOON TOWNSHIP, PA

PRELIMINARY

PLOTTED: 16-JAN-2024 12:04

OPERATOR: wberry
FILE NAME: pw://mb-us-pw-bentley.com:mb-us-pw-01/Documents/MoonTownship_PA/01_Projects/SR_0318_Emergency_Bridge_Replacement/deliverables/plots/profile/430318B07_Profiles.dgn

DISTRICT	COUNTY	ROUTE	SECTION	SHEET
1-0	MERCER	0318	B07	4 OF 5
SHENANGO TOWNSHIP				
REV NO	REVISIONS	DATE	BY	APPD

EXISTING STRUCTURE DATA SR 0318 OVER SR 0376 EB/WB	
STATION	41+00.00
TYPE	FOUR SPAN P/S SPREAD BOX BEAM BRIDGE
SPAN LENGTH	217'-0" TOTAL, 1 @ 37'-0", 1 @ 62'-3", 1 @ 63'-6", 1 @ 49'-9"
UNDERCLEARANCE	14'-0"
CLEAR ROADWAY WIDTH	30'-0"
SKEW	90°00'00"
STRUCTURE NO	S-6196A
BUILT DATE	1964

PROPOSED STRUCTURE DATA SR 0318 OVER SR 0376 EB/WB	
STATION	41+06.00
TYPE	TWO SPAN CONTINUOUS STEEL MULTI-GIRDER BRIDGE
SPAN LENGTH	204'-0" TOTAL, 1 @ 102'-0", 1 @ 102'-0"
UNDERCLEARANCE	16'-11"
ROADWAY WIDTH	35'-0"
SKEW	90°00'00"
STRUCTURE NO	S-42178

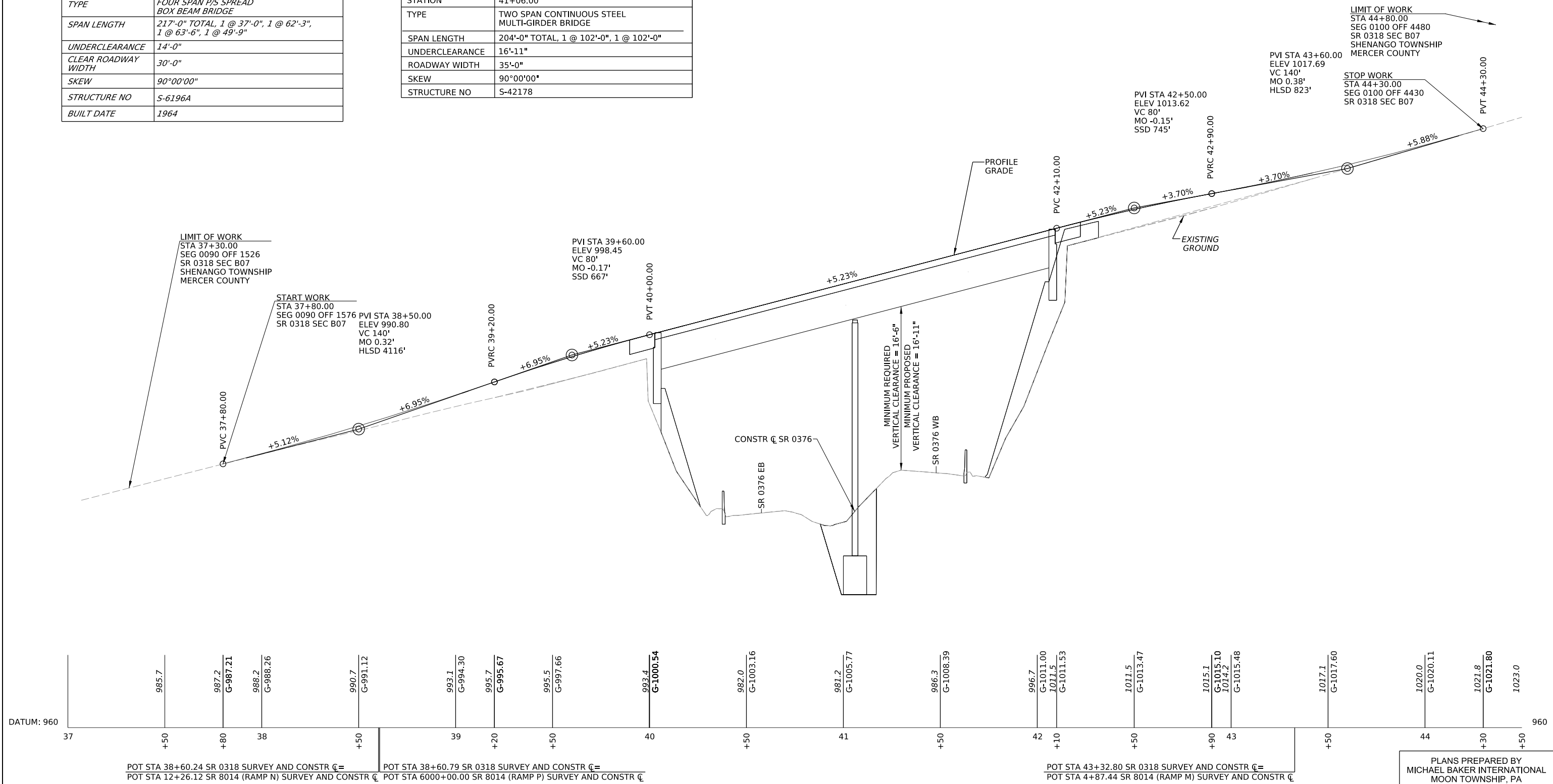

PROFILE - SR 0318

SCALE

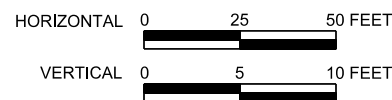

PLANS PREPARED BY
MICHAEL BAKER INTERNATIONAL
MOON TOWNSHIP, PA

PRELIMINARY

SURVEY BOOK # 20689
FOR SR 0318 PLAN, SEE SHEET 3

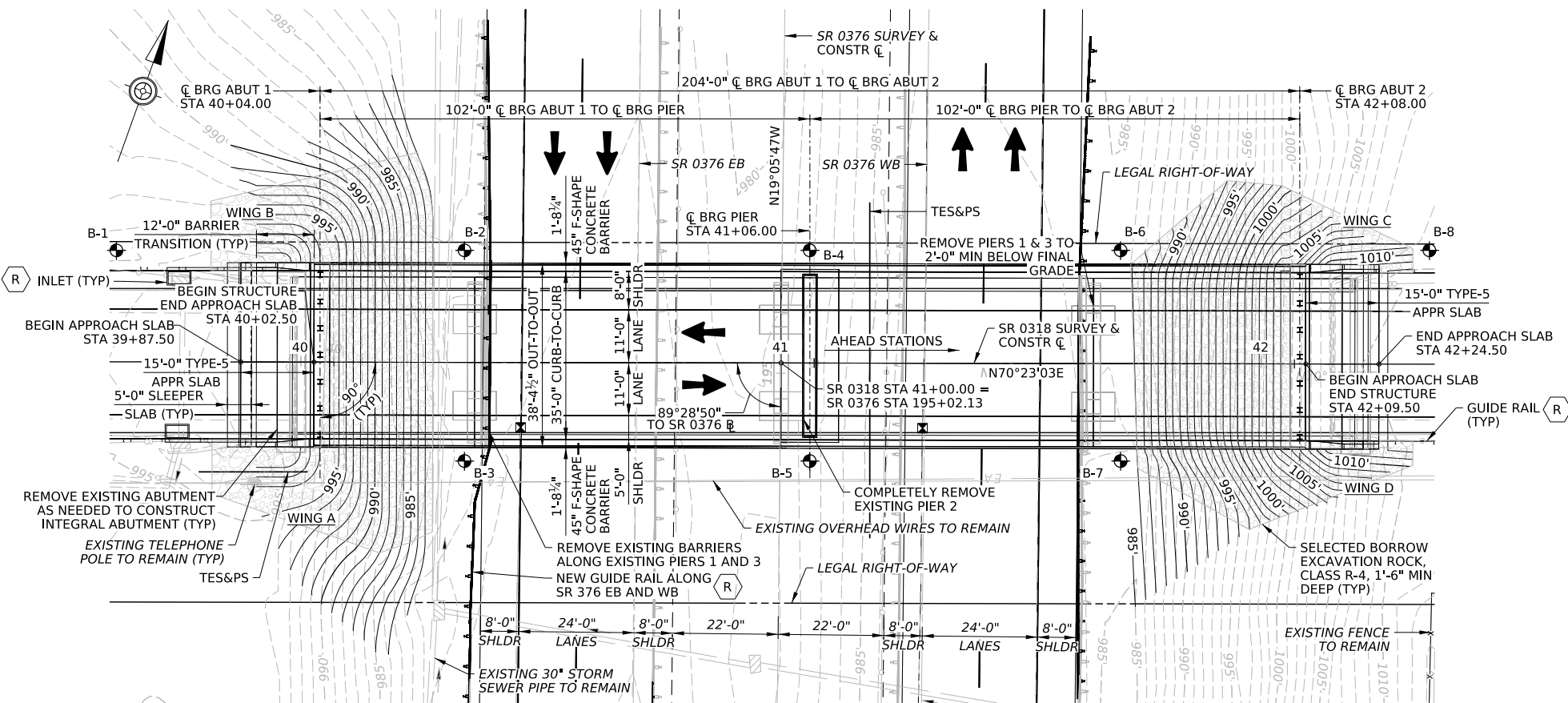

GENERAL PLAN

4 0 8 16 FEET

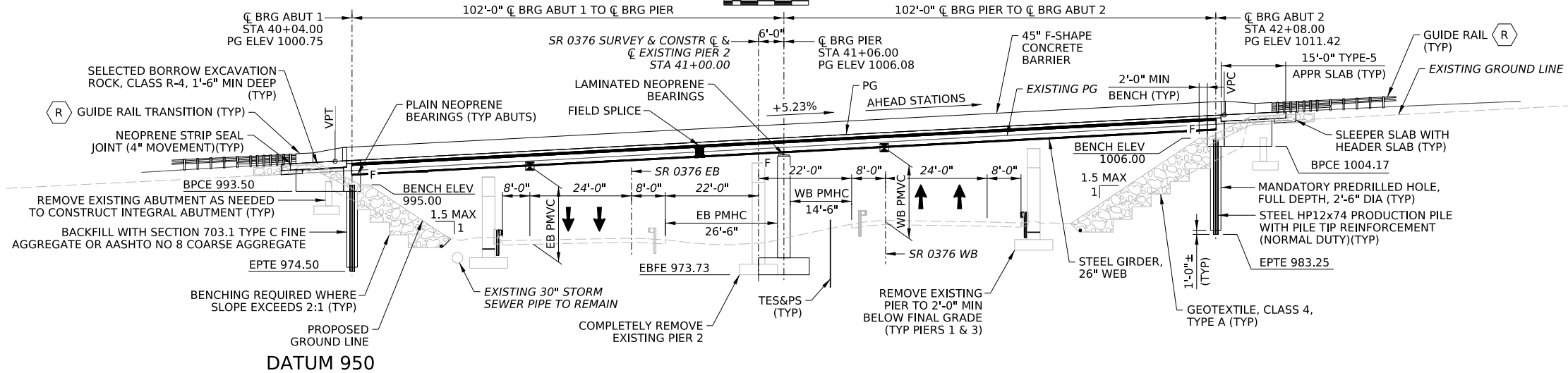

ELEVATION

4 0 8 16 FEET

NOTES:

1. AASHTO LRFD BRIDGE DESIGN SPECIFICATIONS, EIGHTH EDITION, 2017, AND AS SUPPLEMENTED BY DESIGN MANUAL, PART 4, DECEMBER 2019 EDITION.
2. LIVE LOAD DISTRIBUTION TO THE GIRDERS IS BASED UPON DM-4 DISTRIBUTION FACTORS.
3. DESIGN IS IN ACCORDANCE WITH THE LRFD METHOD.
4. DESIGN LIVE LOADS: PHL-93 OR P-82 (204 KIP PERMIT LOAD) OR P2016-13 (330 KIP PERMIT LOAD).
5. DEAD LOADS INCLUDE A 0.015 KSF LOAD FOR STAY-IN-PLACE FORMS, 0.030 KSF LOAD FOR A FUTURE WEARING SURFACE, AND A 0.025 KLF LINE LOAD ALLOWANCE FOR A FUTURE FENCE ON EACH BARRIER.
6. FATIGUE DESIGN IS BASED ON THE FOLLOWING:
ADTT 180 (2044)
(ONE-DIRECTION)

FUTURE REDECKING:
COMPLETELY REMOVE THE END DIAPHRAGMS PRIOR TO DECK REMOVAL TO AVOID SUBJECTING THE GIRDERS TO STRUCTURE AND PAVEMENT TEMPERATURE FORCES AND EARTH PRESSURES.

LEGEND:

- TRAFFIC DIRECTION
- EBFE ESTIMATED BOTTOM OF FOOTING ELEVATION
- F FIXED BEARINGS
- EPT E ESTIMATED PILE TIP ELEVATION
- BPCE BOTTOM OF PILE CAP ELEVATION
- PMHC PROPOSED MINIMUM HORIZONTAL CLEARANCE
- ROADWAY ITEM
- - - EXISTING GROUND CONTOURS (1 FT INTERVALS)
- - - PROPOSED GROUND CONTOURS (1 FT INTERVALS)
- LOCATION OF MINIMUM VERTICAL CLEARANCE
- APPROXIMATE CORE BORING LOCATION
- SELECTED BORROW EXCAVATION ROCK, CLASS R-4
- PG PROFILE GRADE
- EB PMVC EASTBOUND PROPOSED MINIMUM VERTICAL CLEARANCE
MINIMUM REQUIRED = 16'-6"
MINIMUM PROVIDED = 17'-1 1/2"
- WB PMVC WESTBOUND PROPOSED MINIMUM VERTICAL CLEARANCE
MINIMUM REQUIRED = 16'-6"
MINIMUM PROVIDED = 16'-10 3/4"
- TES&PS TEMPORARY EXCAVATION SUPPORT & PROTECTION SYSTEM

Mark	Description	By	Chk'd.	Recm'd.	Date
REVISIONS					

CLASSIFICATION OF EARTHWORK FOR STRUCTURES	RC-11M	06/01/2010
BACKFILL AT STRUCTURES	RC-12M	11/01/2022
GUIDE RAIL TO BRIDGE BARRIER TRANSITIONS	RC-50M	02/27/2023
TYPE 31 STRONG POST GUIDE RAIL	RC-51M	09/01/2023
PERMANENT METAL DECK FORMS	BC-732M	11/23/2022
ANCHOR SYSTEMS	BC-734M	02/19/2021
WALL CONSTRUCTION AND EXPANSION JOINT DETAILS	BC-735M	09/30/2016
REINFORCEMENT BAR FABRICATION DETAILS	BC-736M	11/23/2022
BRIDGE DRAINAGE	BC-751M	01/31/2019
CONCRETE DECK SLAB DETAILS	BC-752M	11/23/2022
STEEL GIRDER DETAILS	BC-753M	01/31/2019
STEEL DIAPHRAGMS FOR STEEL BEAM/GIRDER STRUCTURES (STRAIGHT GIRDERS ONLY)	BC-754M	11/23/2022
BEARINGS	BC-755M	01/31/2019
STEEL PILE TIP REINFORCEMENTS & SPLICES	BC-757M	09/30/2016
NEOPRENE STRIP SEAL FOR PRESTRESSED CONCRETE AND STEEL I-BEAM BRIDGES	BC-767M	11/23/2022
TYPICAL WATERPROOFING AND EXPANSION DETAILS	BC-788M	11/23/2022
DESCRIPTION	DWG NO	RECM'D DATE

SUPPLEMENTAL DRAWINGS

SR 0318 PREVIOUSLY KNOWN AS LR 43007
BMS STR ID: 43-0318-0100-0000
MPMS/ECMS PROJECT: 120915 BRKEY: TBD

COMMONWEALTH OF PENNSYLVANIA
DEPARTMENT OF TRANSPORTATION

MERCER COUNTY
SR 0318 SEC B07

SEGMENT 0100 OFFSET 0000
SR 0318-0100 STA 41+06.00
OVER SR 0376 EB & WB
2 SPAN CONTINUOUS STEEL MULTI-GIRDER BRIDGE

GENERAL PLAN & ELEVATION

RECOMMENDED _____	SHEET 1 OF 2 + SUPPLEMENTAL DRAWINGS
DISTRICT BRIDGE ENGINEER _____	S - 42178

PREPARED BY:
Michael Baker INTERNATIONAL
AIRSIDE BUSINESS PARK
100 AIRSIDE DRIVE
MOON TOWNSHIP, PA 15108
PHONE: (412) 269-6300

PRELIMINARY

1/12/2024 1:19:41 PM p:\mb-us-pw-bentley.com\mb-us-pw-01\Documents\MoonTownship_PA\01_Projects\SR_0318_Emergency_Bridge_Replacement\Deliverables\OpenBridge\SR 318

1/12/2024 1:19:47 PM
 pw://mb-us-pw.bentley.com:mb-us-pw-01/Documents/MoonTownship_PA/01_Projects/SR_0318_Emergency_Bridge_Replacement/deliverables/OpenBridge/SR 318

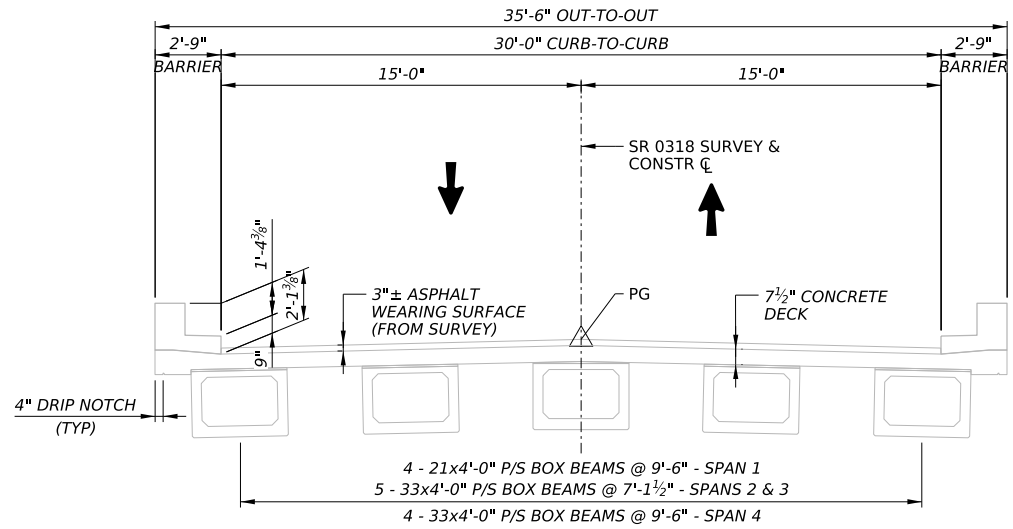

EXISTING TYPICAL SECTION

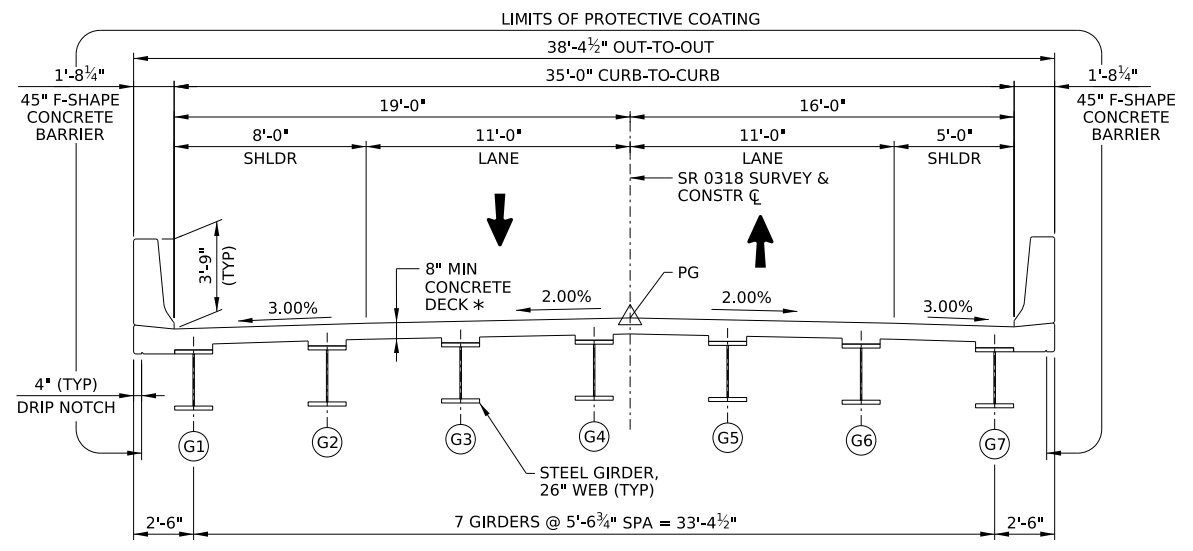
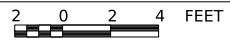

PROPOSED TYPICAL SECTION

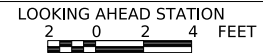

* INCLUDES 1/2" INTEGRAL WEARING SURFACE

SR 0318 HORIZONTAL CURVE DATA

ON TANGENT

SR 0318 VERTICAL CURVE DATA

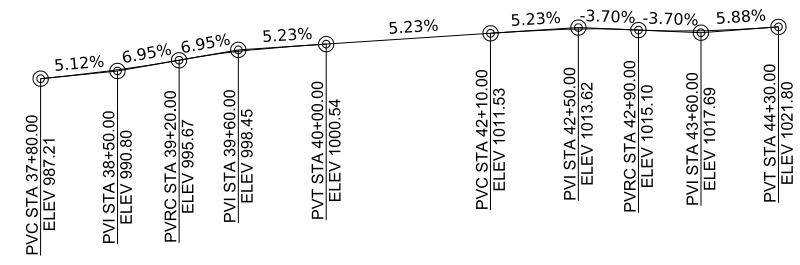

SR 0376 HORIZONTAL CURVE DATA

ON TANGENT

SR 0376 VERTICAL CURVE DATA

FIELD SURVEY ONLY

LEGEND:

- TRAFFIC DIRECTION
- PROFILE GRADE
- GIRDER NUMBER

Mark	Description	By	Chk'd.	Recm'd.	Date
REVISIONS					

SR 0318 PREVIOUSLY KNOWN AS LR 43007
 BMS STR ID: 43-0318-0100-0000
 MPMS/ECMS PROJECT: 120915 BRKEY: TBD

COMMONWEALTH OF PENNSYLVANIA
 DEPARTMENT OF TRANSPORTATION

MERCER COUNTY
 SR 0318 SEC B07

SEGMENT 0100 OFFSET 0000
 SR 0318-0100 STA 41+06.00
 OVER SR 0376 EB & WB
 2 SPAN CONTINUOUS STEEL MULTI-GIRDER BRIDGE

TYPICAL SECTION

RECOMMENDED _____ SHEET 2 OF 2

S - 42178

PRELIMINARY

PLOTTED: 5-JAN-2024 18:07

OPERATOR: wberry
FILE NAME: pw://mb-us-pw.bentley.com:mb-us-pw-01/Documents/MoonTownship_Pa/01_Projects/SR_0318_Emergency_Bridge_Replacement/deliverables/plots/plan/430318B07_Plan.dgn

DISTRICT	COUNTY	ROUTE	SECTION	SHEET
1-0	MERCER	0318	B07	
SHENANGO TOWNSHIP				
REV NO	REVISIONS		DATE	BY APPD

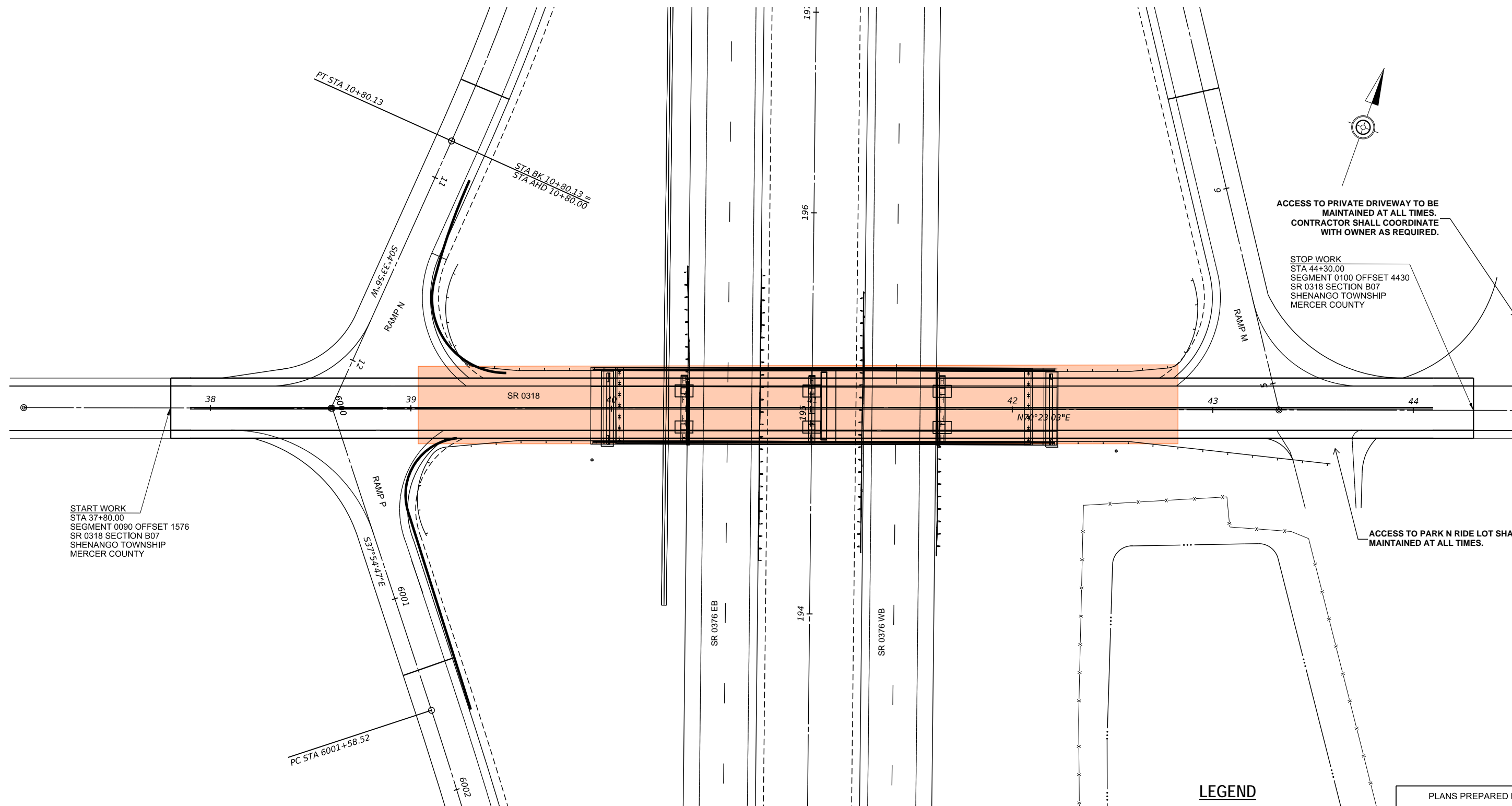

START WORK
 STA 37+80.00
 SEGMENT 0090 OFFSET 1576
 SR 0318 SECTION B07
 SHENANGO TOWNSHIP
 MERCER COUNTY

ACCESS TO PRIVATE DRIVEWAY TO BE
 MAINTAINED AT ALL TIMES.
 CONTRACTOR SHALL COORDINATE
 WITH OWNER AS REQUIRED.

STOP WORK
 STA 44+30.00
 SEGMENT 0100 OFFSET 4430
 SR 0318 SECTION B07
 SHENANGO TOWNSHIP
 MERCER COUNTY

ACCESS TO PARK N RIDE LOT SHALL BE
 MAINTAINED AT ALL TIMES.

GENERAL TRAFFIC INFORMATION (PHASE 1)
SR 0318 TRAFFIC WILL REMAIN DETOURED
ALL RAMP WILL REMAIN OPEN

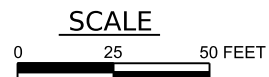

LEGEND

	ACTIVE WORK AREA (CLOSED TO TRAFFIC)
	WORK COMPLETED IN PREVIOUS PHASE(S) - REMAINS CLOSED TO TRAFFIC
	WORK COMPLETED IN PREVIOUS PHASE(S) - OPEN TO TRAFFIC

**TRAFFIC CONTROL PHASING CONCEPT
 PHASE 1**

SURVEY BOOK #

PLANS PREPARED BY

Preliminary

01/11/2024 5:04:16 PM

DES: DWG: CKD:

PLOTTED: 5-JAN-2024 18:07

OPERATOR: wberry
FILE NAME: pw://mb-us-pw-bentley.com:mb-us-pw-01/Documents/MoonTownship_PA01_Projects/SR_0318_Emergency_Bridge_Replacement/deliverables/plots/plan/430318B07_Plan.dgn

DISTRICT	COUNTY	ROUTE	SECTION	SHEET	
1-0	MERCER	0318	B07		
SHENANGO TOWNSHIP					
REV NO	REVISIONS		DATE	BY	APPD

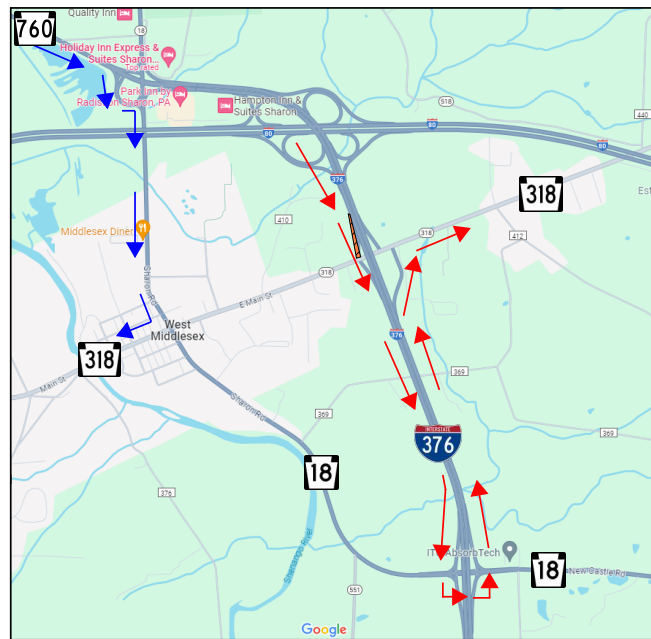

DETAIL - RAMP N DETOUR

ESTIMATED DURATION - 15-20 WORKING DAYS

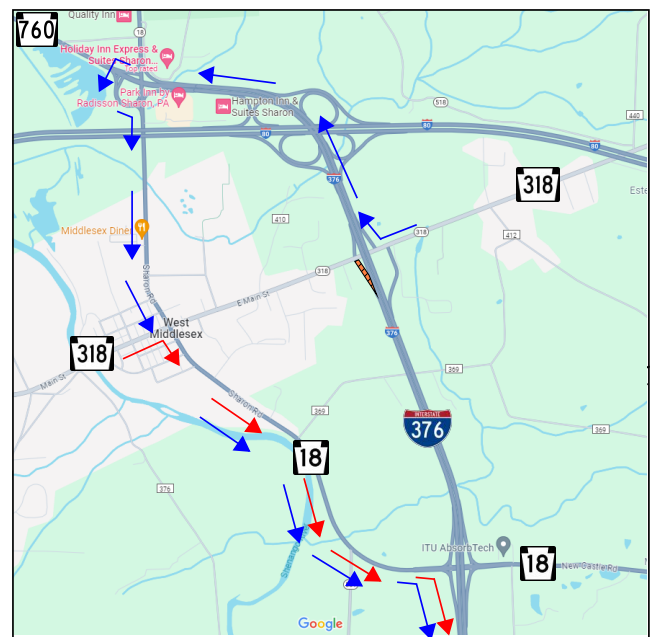

DETAIL - RAMP P DETOUR

ESTIMATED DURATION - 15-20 WORKING DAYS

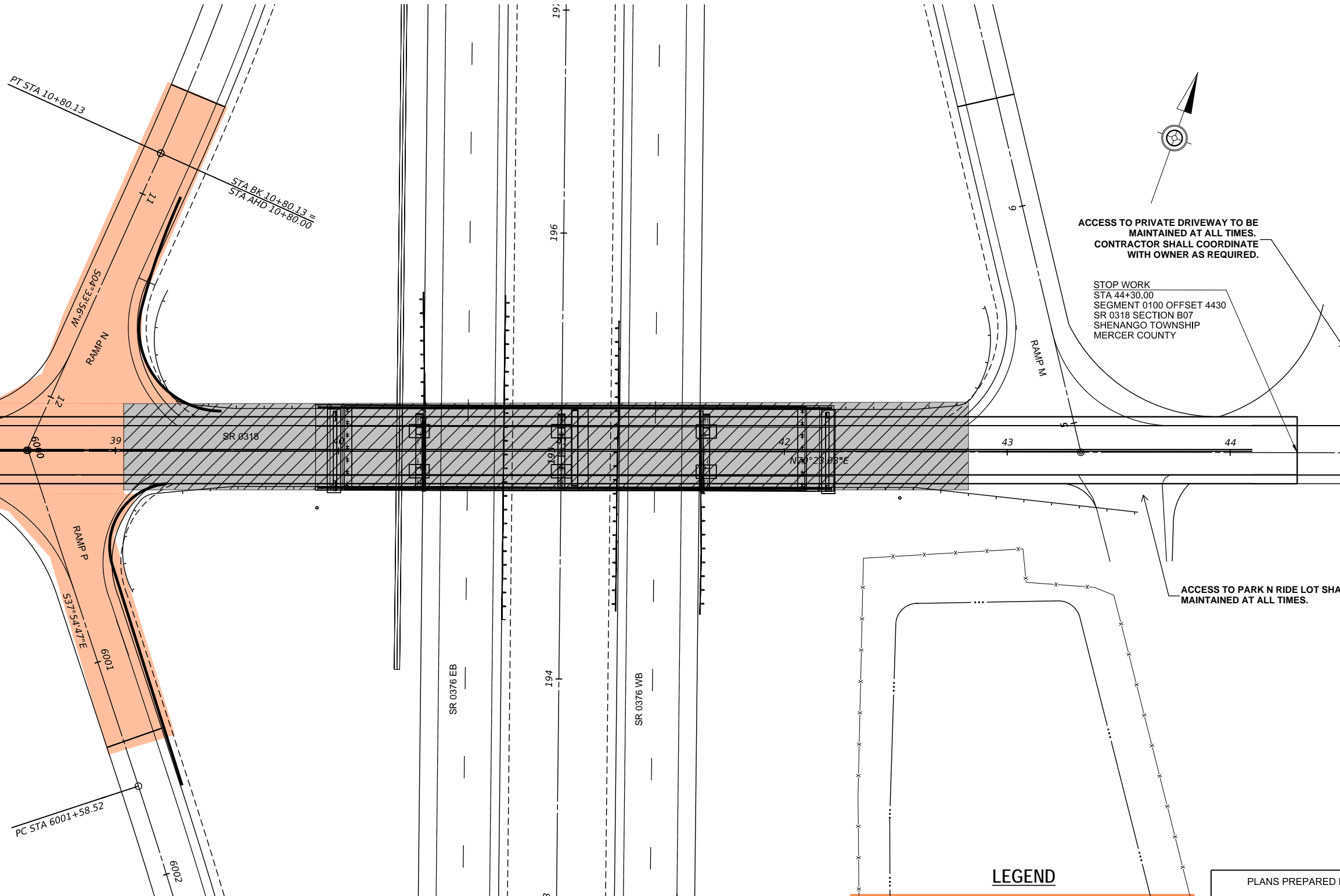

ACCESS TO PRIVATE DRIVEWAY TO BE MAINTAINED AT ALL TIMES. CONTRACTOR SHALL COORDINATE WITH OWNER AS REQUIRED.

STOP WORK
STA 44+30.00
SEGMENT 0100 OFFSET 4430
SR 0318 SECTION B07
SHENANGO TOWNSHIP
MERCER COUNTY

ACCESS TO PARK N RIDE LOT SHALL BE MAINTAINED AT ALL TIMES.

START WORK
STA 37+80.00
SEGMENT 0090 OFFSET 1576
SR 0318 SECTION B07
SHENANGO TOWNSHIP
MERCER COUNTY

GENERAL TRAFFIC INFORMATION (PHASE 2)
SR 0318 TRAFFIC WILL REMAIN DETOURED
RAMP N AND RAMP P WILL BE DETOURED (SEE DETAILS)
RAMP M WILL REMAIN OPEN

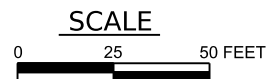

LEGEND

- ACTIVE WORK AREA (CLOSED TO TRAFFIC)
- WORK COMPLETED IN PREVIOUS PHASE(S) - REMAINS CLOSED TO TRAFFIC
- WORK COMPLETED IN PREVIOUS PHASE(S) - OPEN TO TRAFFIC

TRAFFIC CONTROL PHASING CONCEPT PHASE 2

SURVEY BOOK #

PLANS PREPARED BY
Preliminary
01/11/2024 5:04:16 PM

PLOTTED: 5-JAN-2024 18:07

OPERATOR: wberry
FILE NAME: pw://mb-us-pw.bentley.com:mb-us-pw-01/Documents/MoonTownship_PA/01_Projects/SR_0318_Emergency_Bridge_Replacement/deliverables/plots/plan/430318B07_Plan.dgn

DISTRICT	COUNTY	ROUTE	SECTION	SHEET
1-0	MERCER	0318	B07	
SHENANGO TOWNSHIP				
REV NO	REVISIONS		DATE	BY APPD

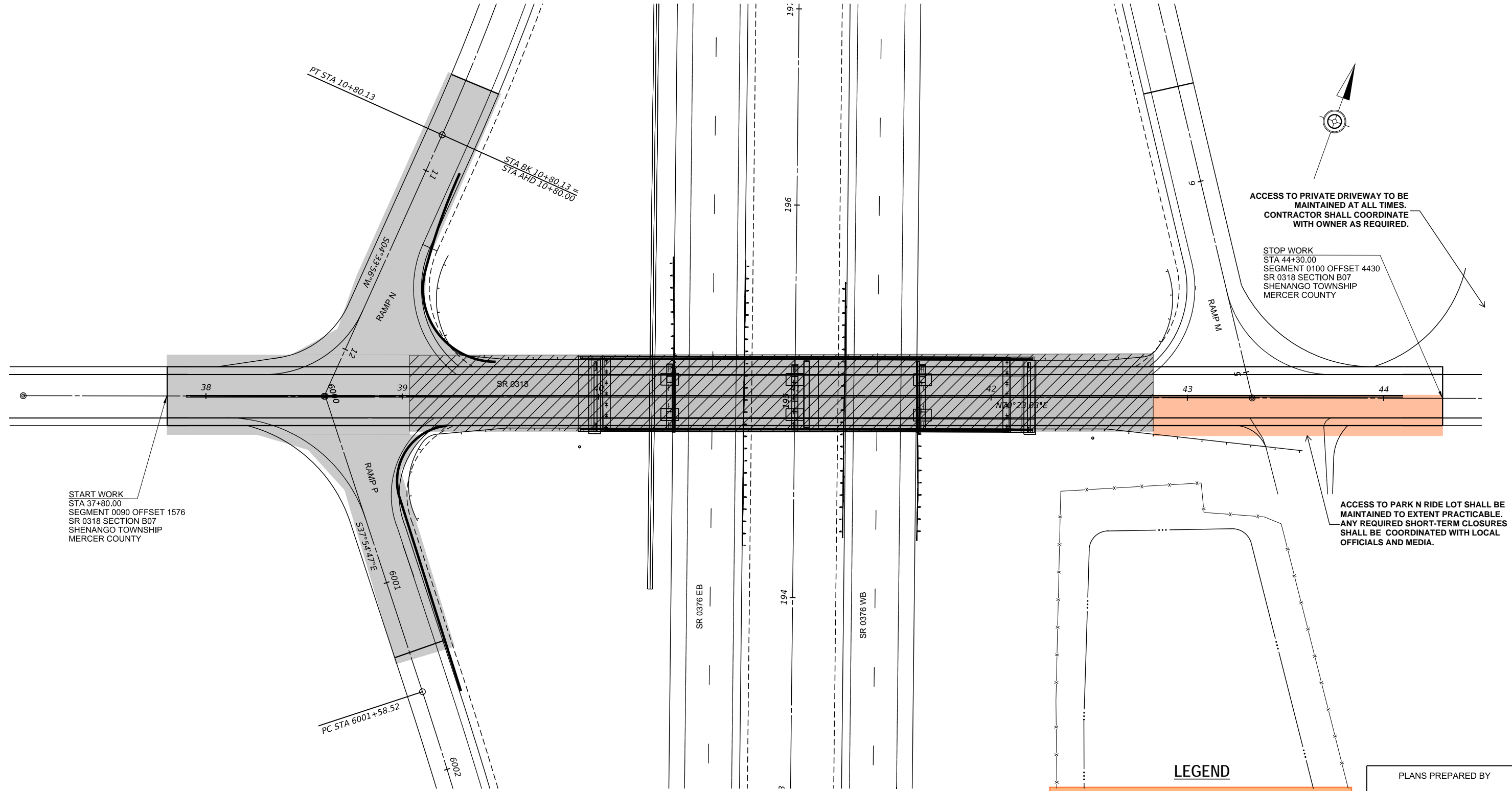

START WORK
 STA 37+80.00
 SEGMENT 0090 OFFSET 1576
 SR 0318 SECTION B07
 SHENANGO TOWNSHIP
 MERCER COUNTY

PT STA 10+80.13
 STA BK 10+80.13 =
 STA AHD 10+80.00

PC STA 6001+58.52

ACCESS TO PRIVATE DRIVEWAY TO BE
 MAINTAINED AT ALL TIMES.
 CONTRACTOR SHALL COORDINATE
 WITH OWNER AS REQUIRED.

STOP WORK
 STA 44+30.00
 SEGMENT 0100 OFFSET 4430
 SR 0318 SECTION B07
 SHENANGO TOWNSHIP
 MERCER COUNTY

ACCESS TO PARK N RIDE LOT SHALL BE
 MAINTAINED TO EXTENT PRACTICABLE.
 ANY REQUIRED SHORT-TERM CLOSURES
 SHALL BE COORDINATED WITH LOCAL
 OFFICIALS AND MEDIA.

GENERAL TRAFFIC INFORMATION (PHASE 3A)
 SR 0318 TRAFFIC WILL REMAIN DETOURED
 RAMP M WILL REMAIN OPEN
 RAMP N AND RAMP P WILL BE RE-OPENED

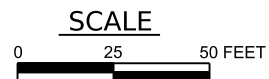

LEGEND

- ACTIVE WORK AREA (CLOSED TO TRAFFIC)
- WORK COMPLETED IN PREVIOUS PHASE(S) - REMAINS CLOSED TO TRAFFIC
- WORK COMPLETED IN PREVIOUS PHASE(S) - OPEN TO TRAFFIC

**TRAFFIC CONTROL PHASING CONCEPT
 PHASE 3A**

SURVEY BOOK #

PLANS PREPARED BY

Preliminary
 01/11/2024 5:04:16 PM

DES: DWG: CKD:

PLOTTED: 5-JAN-2024 18:07

OPERATOR: wberry
FILE NAME: pw://mb-us-pw.bentley.com:mb-us-pw-01/Documents/MoonTownship_PA/01_Projects/SR_0318_Emergency_Bridge_Replacement/deliverables/plots/plan/430318B07_Plan.dgn

DISTRICT	COUNTY	ROUTE	SECTION	SHEET
1-0	MERCER	0318	B07	
SHENANGO TOWNSHIP				
REV NO	REVISIONS	DATE	BY	APPD

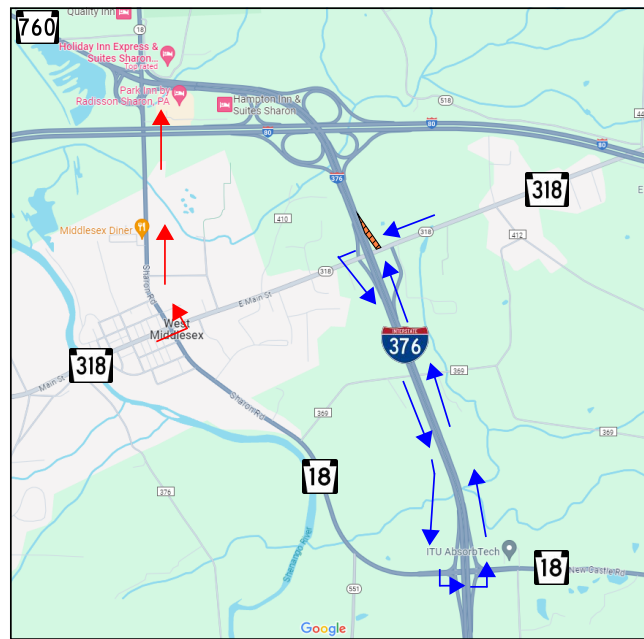

DETAIL - RAMP M DETOUR

ESTIMATED DURATION - 10-15 WORKING DAYS

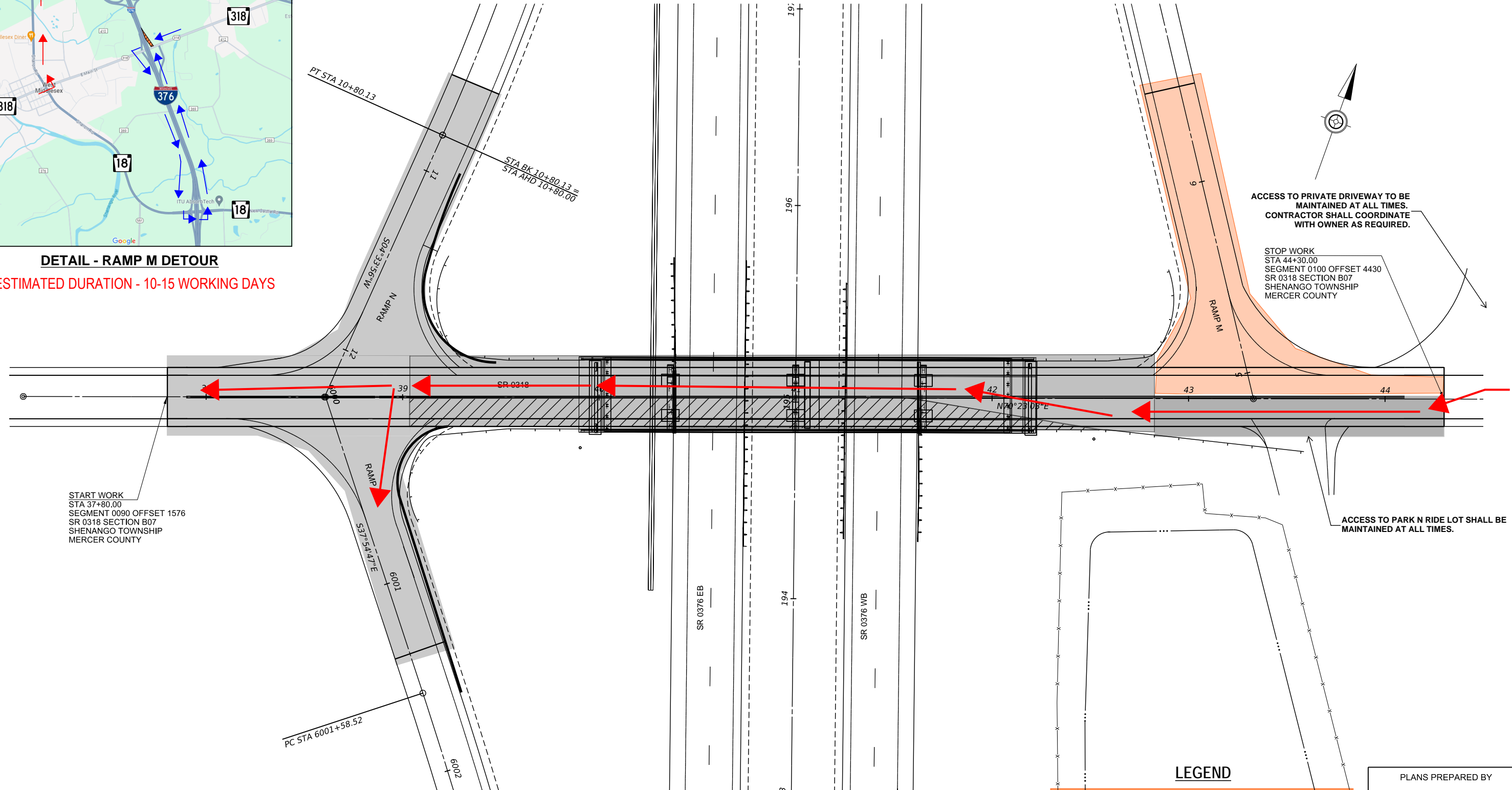

START WORK
 STA 37+80.00
 SEGMENT 0090 OFFSET 1576
 SR 0318 SECTION B07
 SHENANGO TOWNSHIP
 MERCER COUNTY

ACCESS TO PRIVATE DRIVEWAY TO BE
 MAINTAINED AT ALL TIMES.
 CONTRACTOR SHALL COORDINATE
 WITH OWNER AS REQUIRED.

STOP WORK
 STA 44+30.00
 SEGMENT 0100 OFFSET 4430
 SR 0318 SECTION B07
 SHENANGO TOWNSHIP
 MERCER COUNTY

ACCESS TO PARK N RIDE LOT SHALL BE
 MAINTAINED AT ALL TIMES.

GENERAL TRAFFIC INFORMATION (PHASE 3B)
 SR 0318 EASTBOUND TRAFFIC WILL REMAIN DETOURED
 SR 0318 WESTBOUND WILL BE OPENED
 RAMP N AND RAMP P WILL REMAIN OPEN
 RAMP M WILL BE DETOURED (SEE DETAIL)

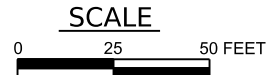

LEGEND

	ACTIVE WORK AREA (CLOSED TO TRAFFIC)
	WORK COMPLETED IN PREVIOUS PHASE(S) - REMAINS CLOSED TO TRAFFIC
	WORK COMPLETED IN PREVIOUS PHASE(S) - OPEN TO TRAFFIC

**TRAFFIC CONTROL PHASING CONCEPT
PHASE 3B**

SURVEY BOOK #

PLANS PREPARED BY

Preliminary
01/11/2024 5:04:10 PM

DES: DWG: CKD:

ROUTE 318 DETOUR - DETOUR CURRENTLY IN PLACE WILL REMAIN DURING CONSTRUCTION

DISTRICT	COUNTY	ROUTE	SECTION	SHEET
1-0	MERCER	0318	EMERGENCY	2 OF 2
SHENANGO TOWNSHIP				
REV NO	REVISIONS	DATE	BY	APPD

PLOTTED: 8-DEC-2023 12:09

OPERATOR: PDowning
FILE NAME: p:\PDEDPRAPPW01.pennndot\dot\Traffic\Operations\Mercer\430318EMGCY_TCP.dgn

CMS
 PA EAST 318 FOLLOW DETOUR
 3-LINE CHANGEABLE MESSAGE SIGN WITH TELECOMMUNICATIONS
 + = LARGER SIZE FOR HIGHWAY USE

LEGEND

- PROJECT AREA
- TYPE B WARNING LIGHT
- ⚡ TYPE III BARRICADE
- ▬ SIGN POST
- ▴ WESTBOUND DETOUR ROUTE
- ▭ EASTBOUND DETOUR ROUTE

NOT TO SCALE

