

PLOTTED: 8-JUN-2023 12:31

OPERATOR: \$USER\$\$
FILE NAME: Z:\\$PROJECT\\$PRJ\ec1s\058492076 SR 3015\08 CAD\dwg\Br1dpe\T&S\0353015270_S.STRUCT.001_GENERAL PLAN.dgn
PENTABLE: \$PENTBL\$

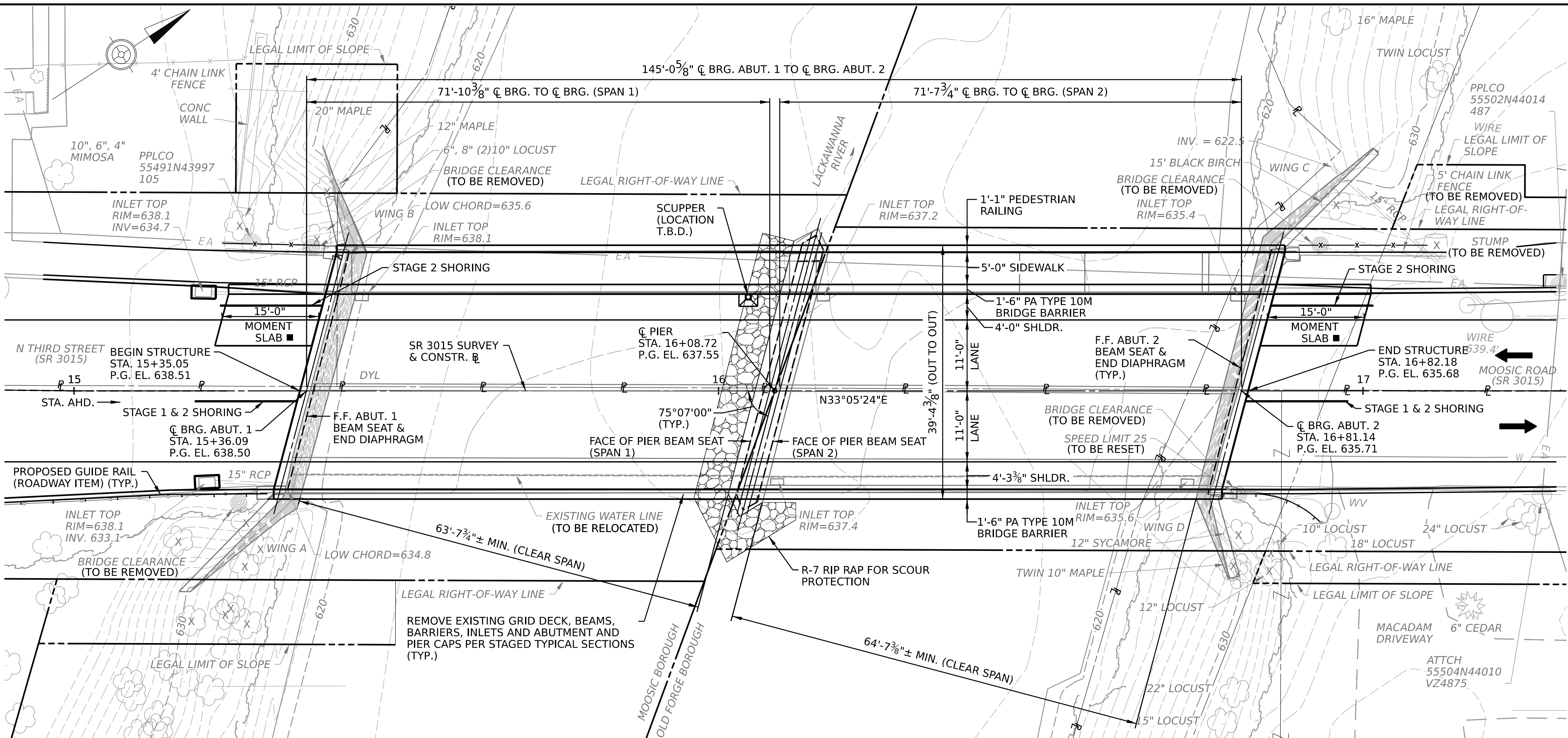

PLAN
5 0 5 10 FEET

NOTE:
BEG/END STRUCTURE STATIONS AND C BEARING STATIONS TO BE CONFIRMED IN FINAL DESIGN WITH BEARING DESIGNS AND SUPPLEMENTAL SURVEY.

■ MOMENT SLAB INCLUDES CUSTOM VERTICAL WALL BARRIER TRANSITION TO REDUCE HEIGHT FROM 3'-10" TO 8" TO TRANSITION TO APPROACH SIDEWALK. DETAILS TO BE CONFIRMED IN FINAL DESIGN.

HYDRAULIC DATA

DRAINAGE AREA = 255 SQ. MI.
DESIGN FLOOD FREQUENCY = 25 YR.
MAGNITUDE = 15,511 C.F.S.

EXISTING	PROPOSED
VELOCITY = 8.03 F.P.S.	8.03 F.P.S.
WATER SURFACE EL. = 632.41	632.41
FREQUENCY = 100 YR.	
MAGNITUDE = 20,277 C.F.S.	
EXISTING	PROPOSED
VELOCITY = 4.71 F.P.S.	4.71 F.P.S.
WATER SURFACE EL. = 637.34	637.34

INDEX OF DRAWINGS

SHT. NO.	DESCRIPTION
1	TYPE, SIZE AND LOCATION PLAN
2	GENERAL NOTES
3	TYPICAL SECTIONS - STAGED CONSTR. 1
4	TYPICAL SECTIONS - STAGED CONSTR. 2

EXISTING STRUCTURE DATA	PROPOSED STRUCTURE DATA
STATION - 16+08.72	STATION - 16+08.72
TYPE - TWO SPAN, STEEL I-BEAM WITH CONCRETE FILLED STEEL GRID DECK	TYPE - TWO SPAN, STEEL PLATE GIRDER WITH COMPOSITE REINFORCED CONCRETE DECK
LENGTH - 72'-4 3/4" ± (SPAN 1) 72'-4 3/4" ± (SPAN 2)	LENGTH - 71'-10 3/8" (SPAN 1) 71'-7 3/4" (SPAN 2)
SPAN - 63'-7 3/4" ± CLR. (SPAN 1) 64'-7 3/8" ± CLR. (SPAN 2)	SPAN - 63'-7 3/4" ± CLR. (SPAN 1) 64'-7 3/8" ± CLR. (SPAN 2)
SKEW - 75°00'00" ±	SKEW - 75°07'00"
ROADWAY - 37'-11 3/8" ± OUT TO OUT 30'-0" CURB TO CURB	ROADWAY - 39'-4 3/8" OUT TO OUT 30'-3 3/8" CURB TO CURB

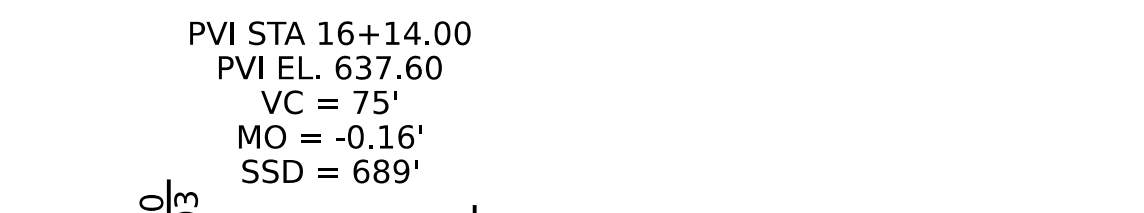

VERTICAL CURVE DATA
HORIZONTAL CURVE DATA

LEGEND

- EXISTING CONTOUR -
- TRAFFIC FLOW DIRECTION -
- PROPERTY LINE -
- EXISTING UTILITY POLE -
- EXISTING OVERHEAD ELECTRIC -
- EXISTING STORM SEWER LINE -
- EXISTING SIGN -
- EXISTING FENCE -
- EXISTING WATER LINE -
- PROPOSED FENCE -
- TEMPORARY EXCAVATION -
- SUPPORT & PROTECTION SYSTEM (SHORING)

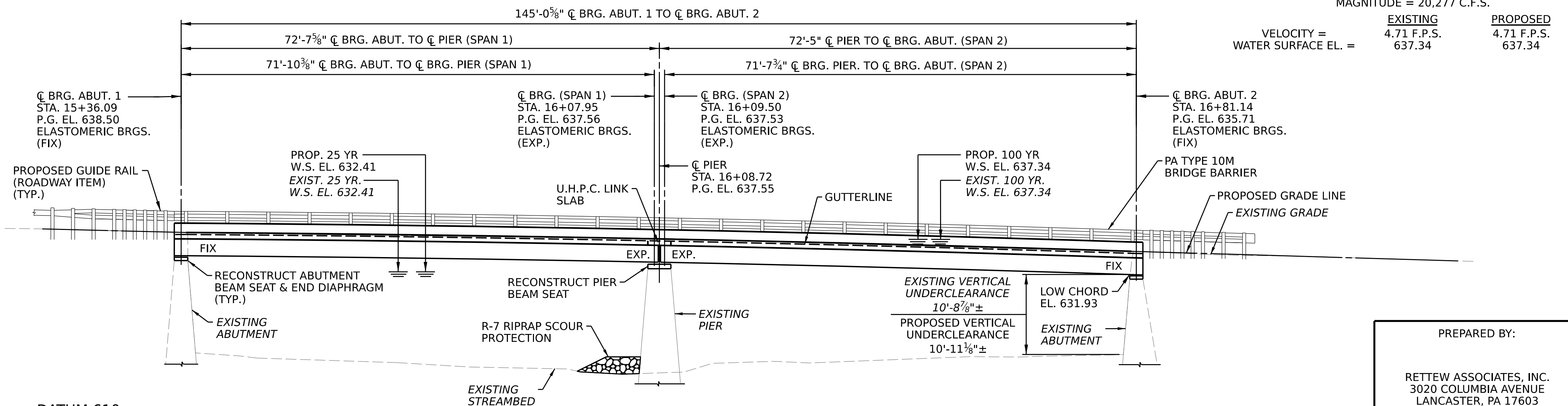

ELEVATION
(LOOKING UPSTREAM)
5 0 5 10 FEET

NOTES:
1. FOR SUPPLEMENTAL DRAWINGS SEE SHEET 2.
2. FOR LIST OF ABBREVIATIONS SEE SHEET 2.
3. FOR SCOPE OF WORK, SEE SHEET 2.

Mark	Description	By	Chk'd	Recm'd.	Date
REVISIONS					

SR 3015 PREVIOUSLY KNOWN AS LR 35064
BMS STR ID: 35-3015-0020-0000 MPMS/ECMS PROJ: 8230 BRKEY: 20775

**COMMONWEALTH OF PENNSYLVANIA
DEPARTMENT OF TRANSPORTATION**

LACKAWANNA COUNTY
SR 3015, SECTION 270
SEGMENT 0020 OFFSET 0000
STA. 16+08.72
OVER LACKAWANNA RIVER
TWO SPAN STEEL PLATE GIRDER
SUPERSTRUCTURE REPLACEMENT

TYPE, SIZE AND LOCATION PLAN

PREPARED BY:
RETTEW ASSOCIATES, INC.
3020 COLUMBIA AVENUE
LANCASTER, PA 17603
(717) 394-3721

DES: PRS	CKD: SVL
DWG: MLH	CKD: PRS

PLOTTED: 8-JUN-2023 09:36

OPERATOR: \$USER\$\$
 FILE NAME: Z:\\$PROJECT\\$P\proj\ec1s\05849\058492076 SR 3015\08 CAD\vgm\Br1dgn\TS&L\0353015270..STRUCT_003_STAGED_CONSTR.dgn
 PENTABLE: \$PENTBL\$

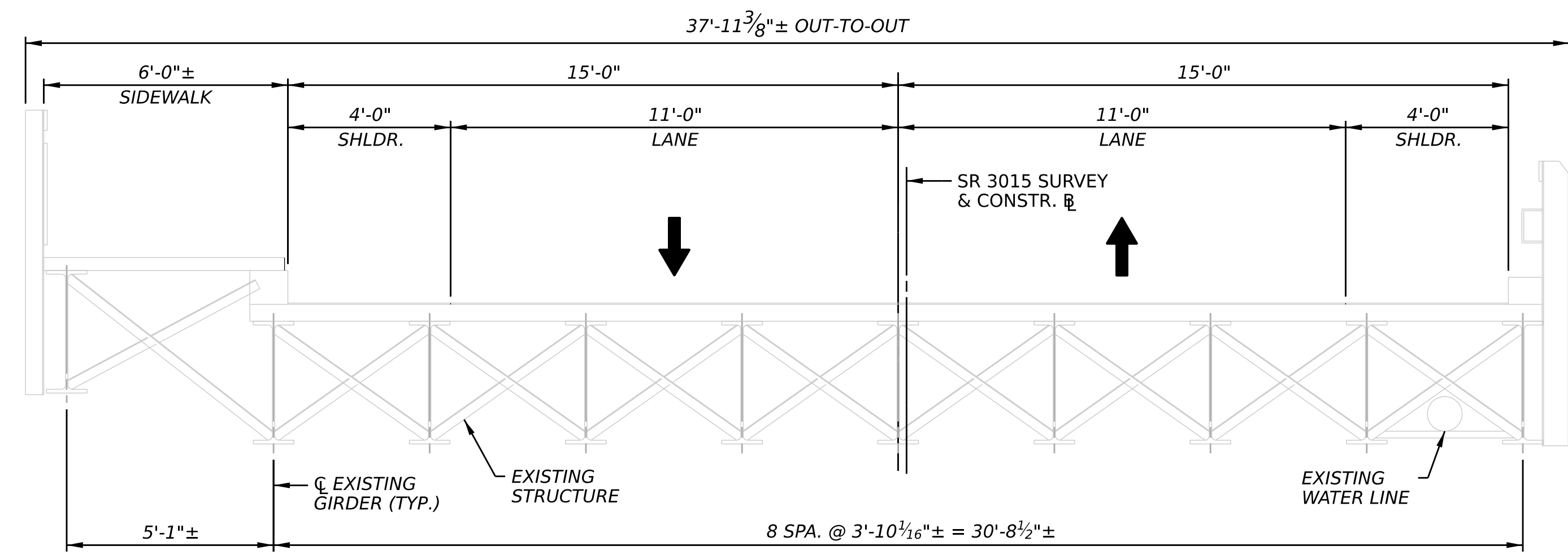

TYPICAL SECTION - EXISTING BRIDGE
 (LOOKING AHEAD STATION)

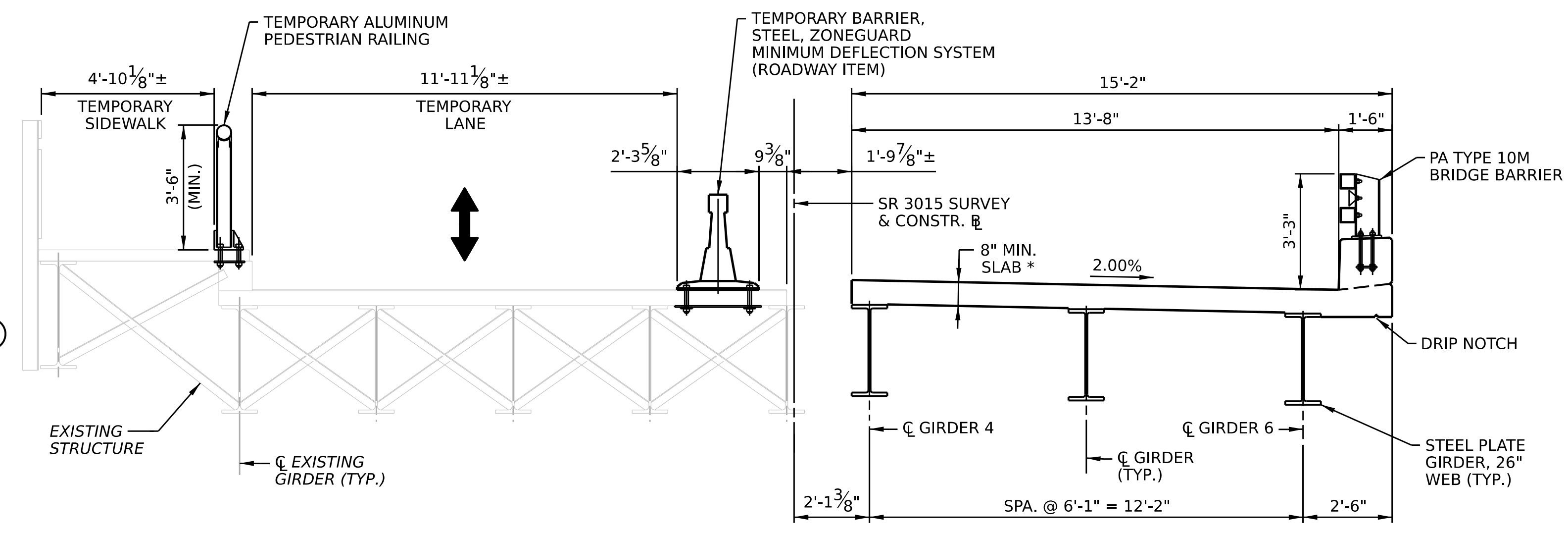
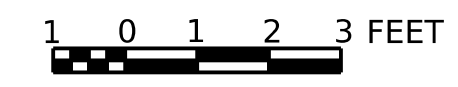

TYPICAL SECTION - STAGE 1
 (LOOKING AHEAD STATION)

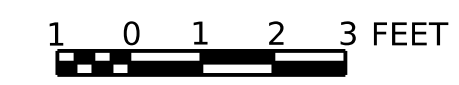

* INCLUDES 1/2" INTEGRAL WEARING SURFACE

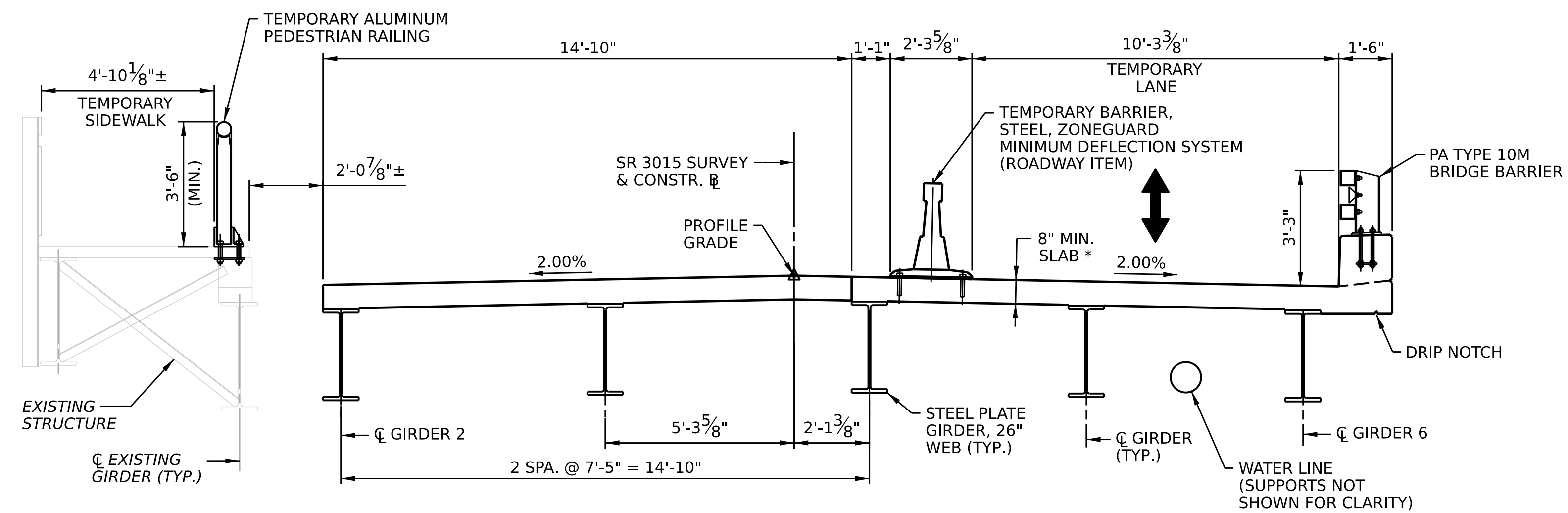

TYPICAL SECTION - STAGE 2
 (LOOKING AHEAD STATION)

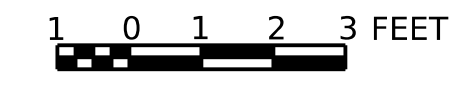

* INCLUDES 1/2" INTEGRAL WEARING SURFACE

Mark	Description	By	Chk'd	Recm'd.	Date
REVISIONS					

SR 3015 PREVIOUSLY KNOWN AS LR 35064
 BMS STR ID: 35-3015-0020-0000 MPMS/ECMS PROJ: 8230 BRKEY: 20775

**COMMONWEALTH OF PENNSYLVANIA
 DEPARTMENT OF TRANSPORTATION**

LACKAWANNA COUNTY
 SR 3015, SECTION 270
 SEGMENT 0020 OFFSET 0000
 STA. 16+08.72
 OVER LACKAWANNA RIVER
 TWO SPAN STEEL PLATE GIRDER
 SUPERSTRUCTURE REPLACEMENT

TYPICAL SECTIONS - STAGED CONSTR. 1

SHEET 3 OF 4

S - XXXXX

DES:	PRS	CKD:	SVL
DWG:	MLH	CKD:	PRS

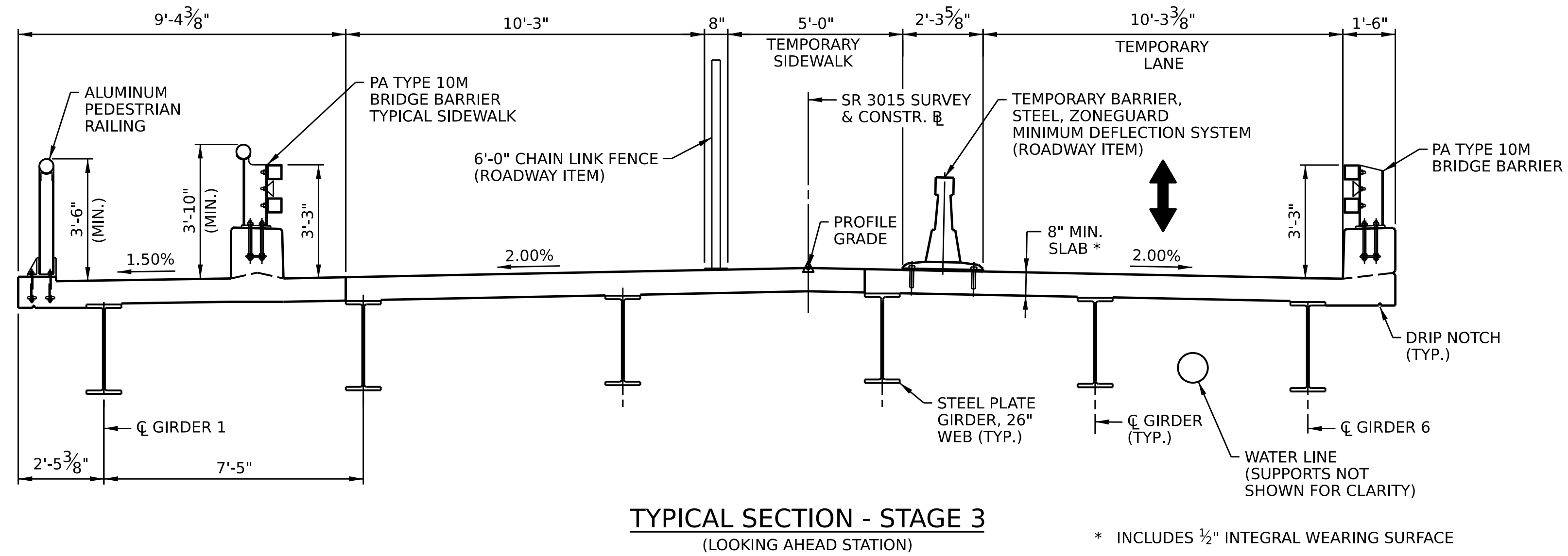

TYPICAL SECTION - STAGE 3
(LOOKING AHEAD STATION)

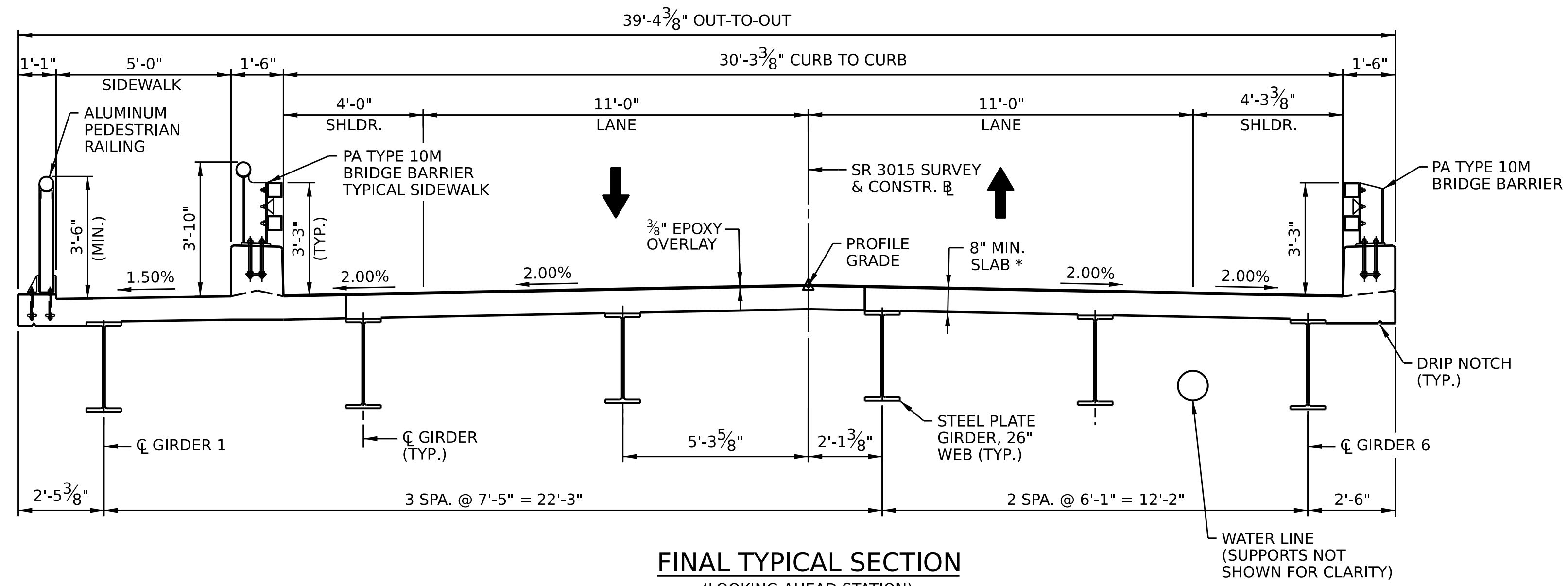
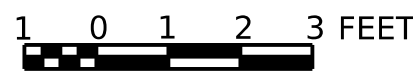

FINAL TYPICAL SECTION
(LOOKING AHEAD STATION)

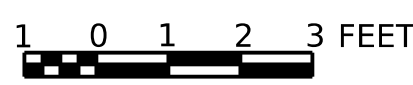

Mark	Description	By	Chk'd	Recm'd.	Date
REVISIONS					

SR 3015 PREVIOUSLY KNOWN AS LR 35064
 BMS STR ID: 35-3015-0020-0000 MPMS/ECMS PROJ: 8230 BRKEY: 20775

**COMMONWEALTH OF PENNSYLVANIA
 DEPARTMENT OF TRANSPORTATION**

LACKAWANNA COUNTY
 SR 3015, SECTION 270
 SEGMENT 0020 OFFSET 0000
 STA. 16+08.72
 OVER LACKAWANNA RIVER
 TWO SPAN STEEL PLATE GIRDER
 SUPERSTRUCTURE REPLACEMENT

TYPICAL SECTIONS - STAGED CONSTR. 2

DES: PRS	CKD: SVL
DWG: MLH	CKD: PRS