

PENNSYLVANIA AVENUE OVER DELAWARE CANAL BRIDGE IMPROVEMENT PROJECT

AGENDA

- Project Description
- Purpose & Need Statement
- Existing Conditions/Photos
- Proposed Design
- Safety Enhancements
- Before and After Photos/Renderings
- During Construction
- Traffic/Pedestrian/Towpath Detours
- Next Steps
- Questions



PROJECT DESCRIPTION

Replacement of the Pennsylvania Avenue Bridge over the Delaware Canal in Morrisville Borough



Existing Bridge Structure:

- 68 foot long, two lanes with sidewalks, single-span structure
- Concrete deck with bituminous wearing surface on multiple steel I-beams
- Supported on reinforced concrete abutments
- Built in 1930



PROJECT PURPOSE AND NEED

The project's purpose is to provide a safe and reliable crossing over the Delaware Canal for the public, public utilities, and emergency services.



The Pennsylvania Avenue bridge is in poor condition:

- Steel beams have moderate to severe rust with minor to advanced section loss.
- Support abutments have fine to wide cracks with some delaminated areas.
- The non-standard, steel lattice bridge railings exhibit bent or broken bars.



EXISTING CONDITION



Heading North on
PA Avenue

Bridge Roadway

PA Avenue Looking North



EXISTING CONDITION



Heading South
on PA Avenue

Bridge Roadway

PA Avenue Bridge Looking South



EXISTING CONDITION



PA Avenue Bridge

Delaware Canal Towpath

Delaware Canal

Bridge Elevation View



EXISTING CONDITION



PROPOSED DESIGN

A 69-foot-long, single-span bridge with two lanes and sidewalks

Concrete deck on multiple steel I-beams supported on reinforced concrete abutments

An improved roadway drainage system north of the bridge

A reconstructed towpath beneath the bridge

Replacement of retaining walls northeast and southwest of the bridge



Pennsylvania Avenue over Delaware Canal Bridge Replacement Project - Proposed



PROPOSED DESIGN

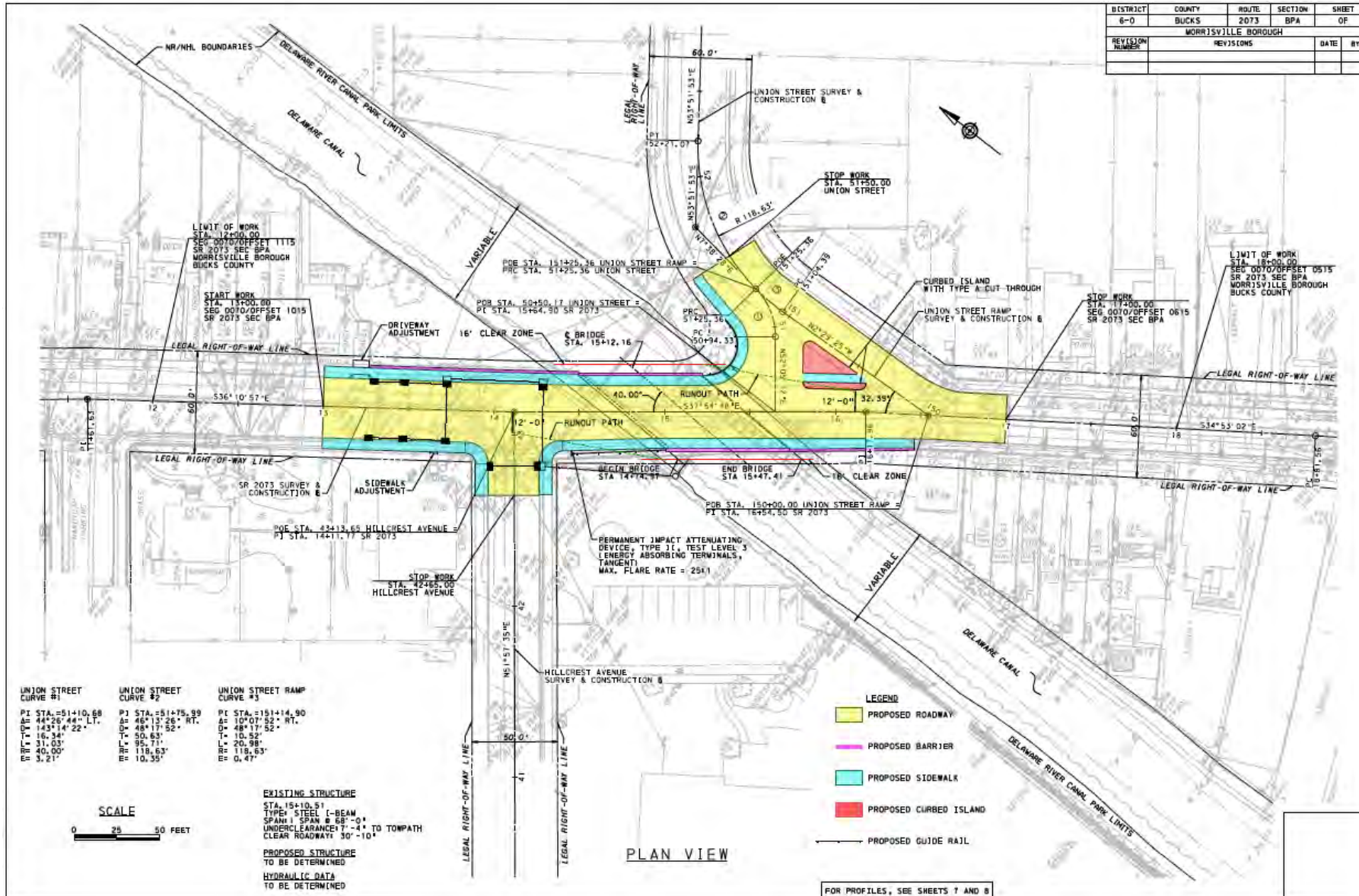

PROPOSED DESIGN



SAFETY ENHANCEMENTS

New Guiderail and Bridge/Roadway Barriers

Union Street Pedestrian Island

Towpath Alignment

Crosswalk Striping



PA Ave and Union St intersection, looking at Union St



BEFORE AND AFTER



BEFORE AND AFTER



DURING CONSTRUCTION

- Construction Duration – 2 years
- Vehicular, Pedestrian and Towpath Detours



TRAFFIC DETOUR

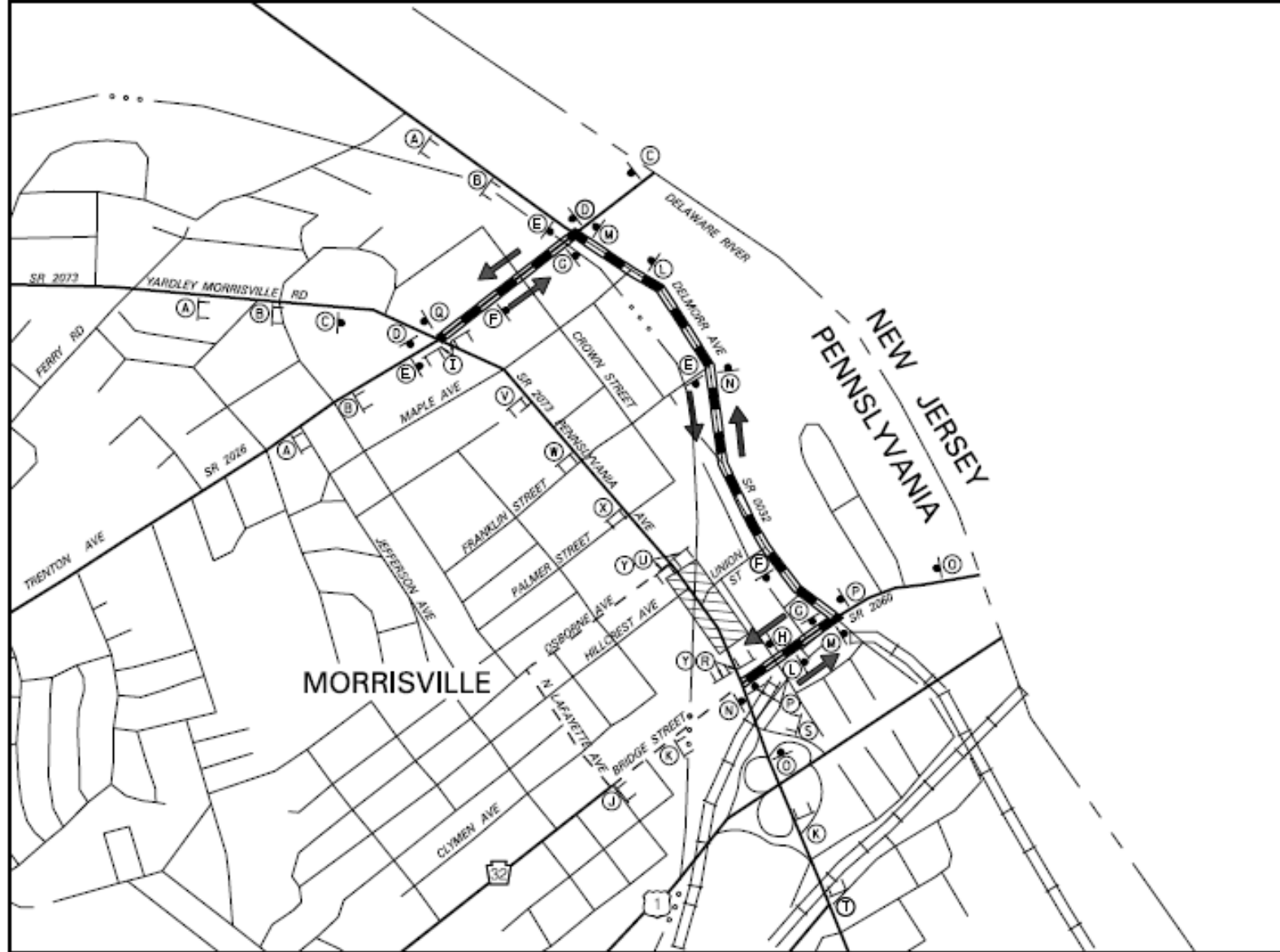

PEDESTRIAN DETOUR

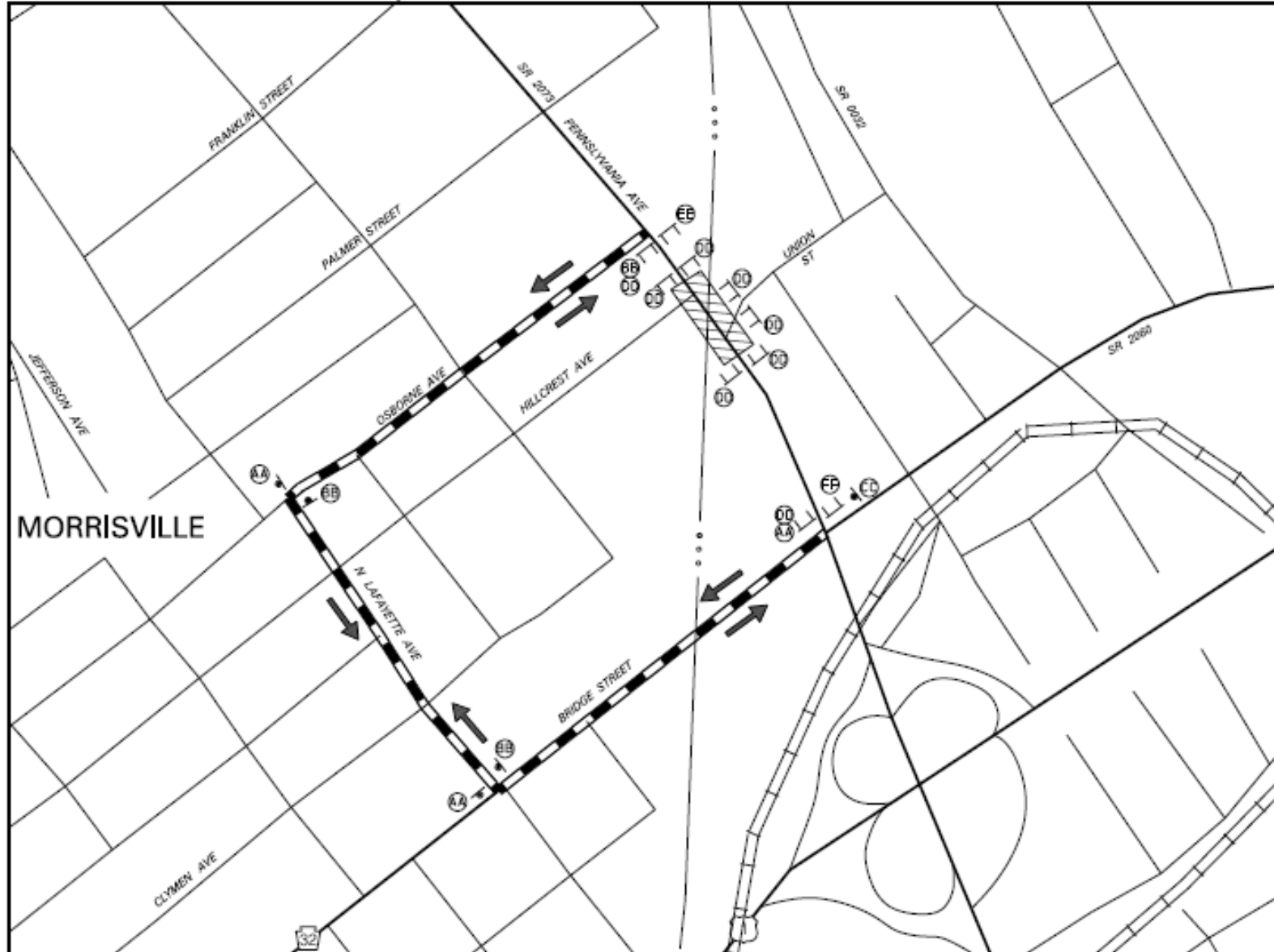

TOWPATH DETOUR

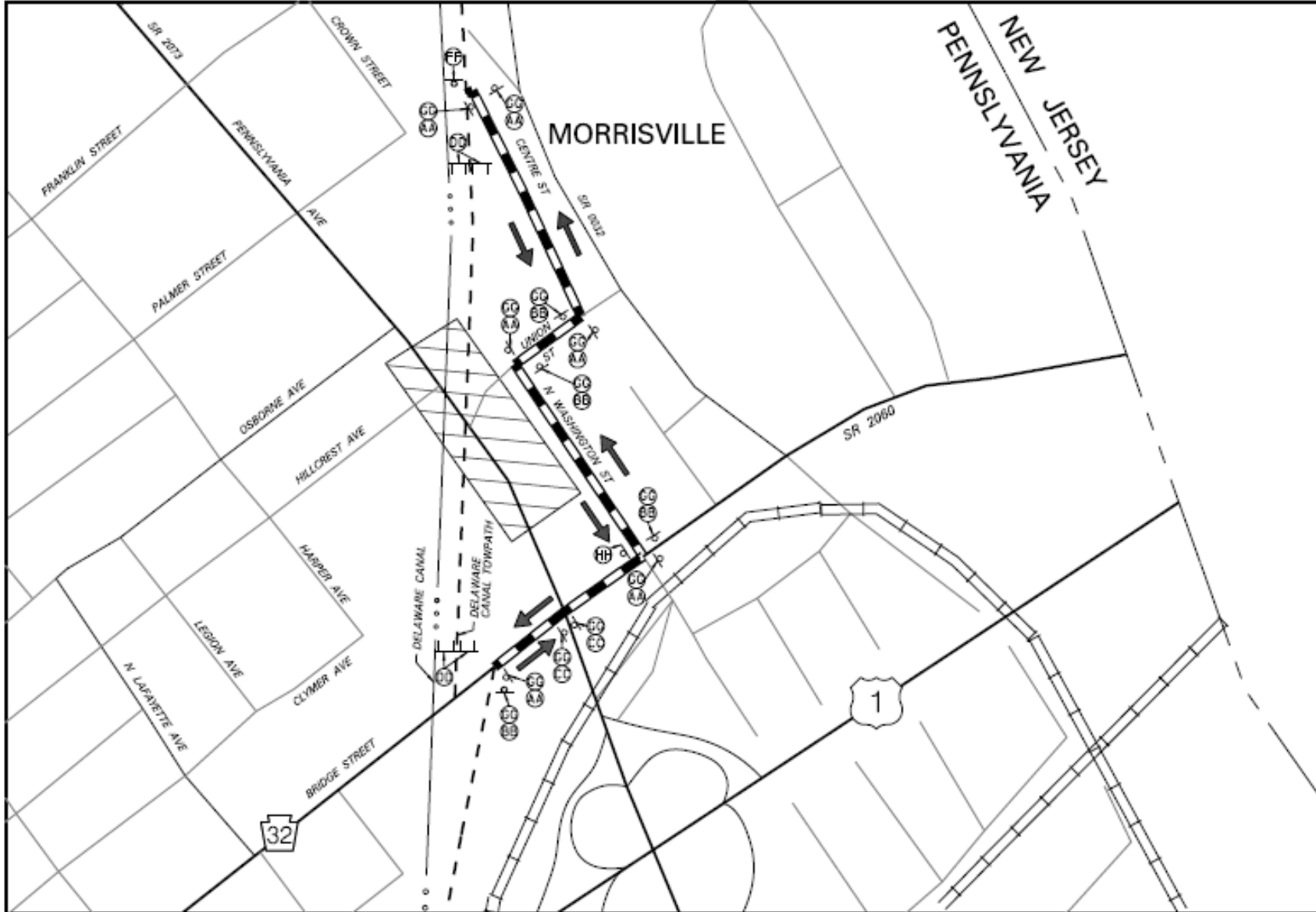

NEXT STEPS

- Categorical Exclusion (Environmental Document)
- Final Design, Right of Way, and Utilities
- Permitting
- Anticipated Construction – Summer 2024



QUESTIONS

THANK YOU