

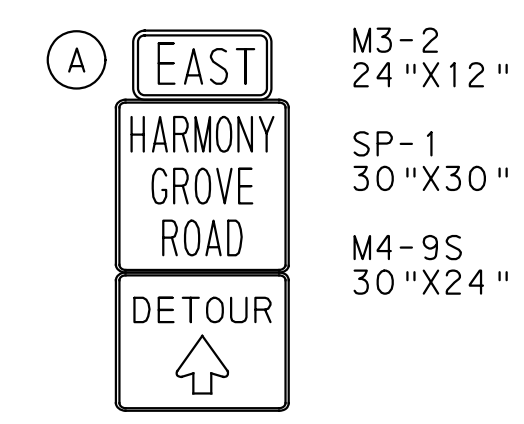

DISTRICT	COUNTY	ROUTE	SECTION	SHEET
8-0	YORK	4014	008	2 OF 2
WARRINGTON TWP & DOVER TWP				
REVISION NUMBER	REVISIONS	DATE	BY	

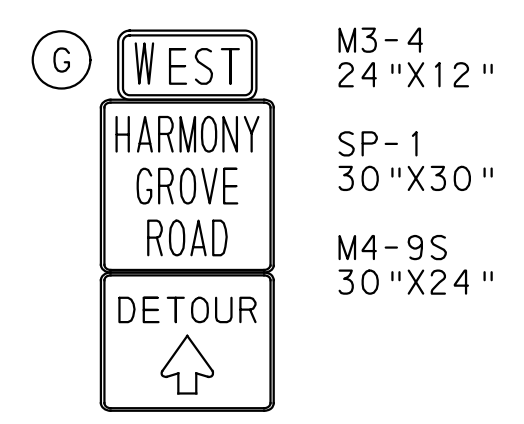

M3-2  
24"x12"  
SP-1  
30"x30"  
M4-9S  
30"x24"



M3-4  
24"x12"  
SP-1  
30"x30"  
M4-9S  
30"x24"

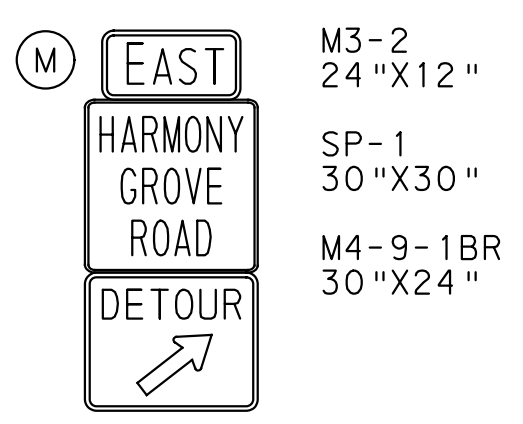

M3-2  
24"x12"  
SP-1  
30"x30"  
M4-9-1BR  
30"x24"

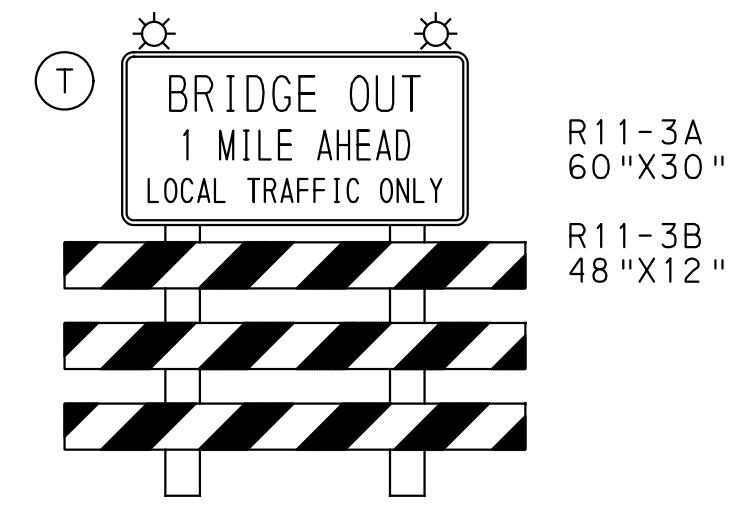

R11-3A  
60"x30"  
R11-3B  
48"x12"

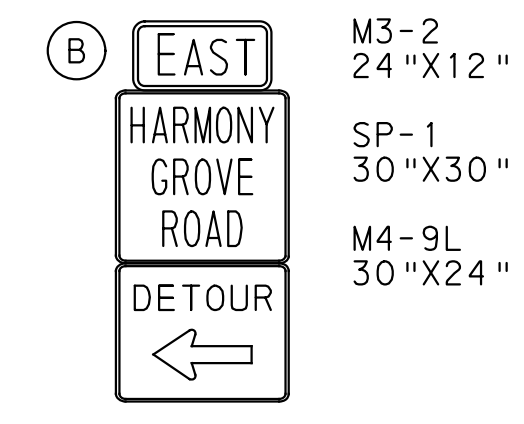

M3-2  
24"x12"  
SP-1  
30"x30"  
M4-9L  
30"x24"

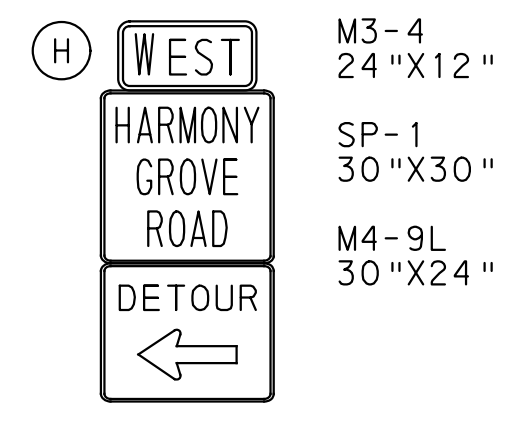

M3-4  
24"x12"  
SP-1  
30"x30"  
M4-9L  
30"x24"

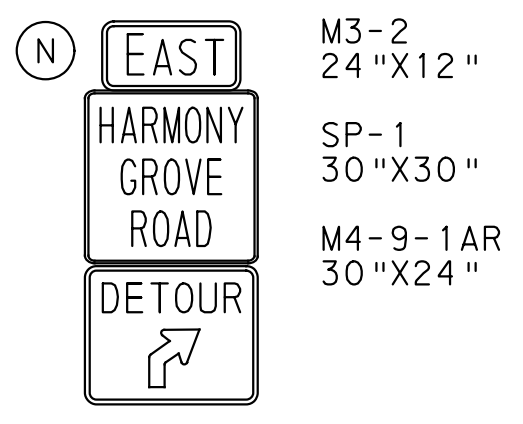

M3-2  
24"x12"  
SP-1  
30"x30"  
M4-9-1AR  
30"x24"

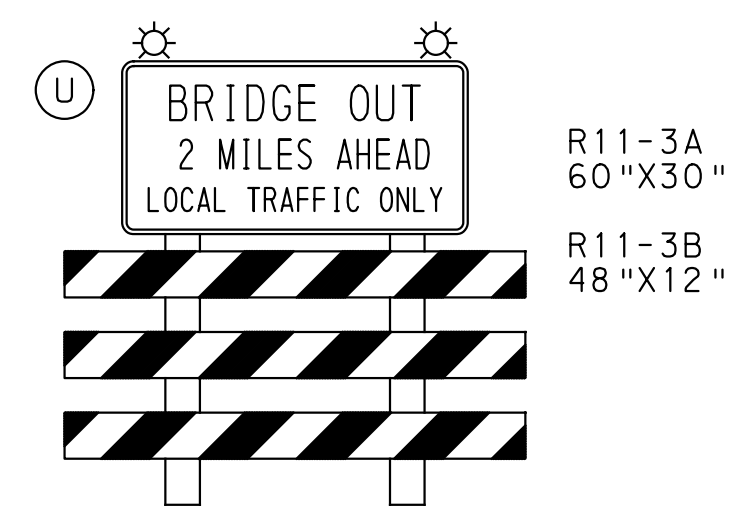

R11-3A  
60"x30"  
R11-3B  
48"x12"

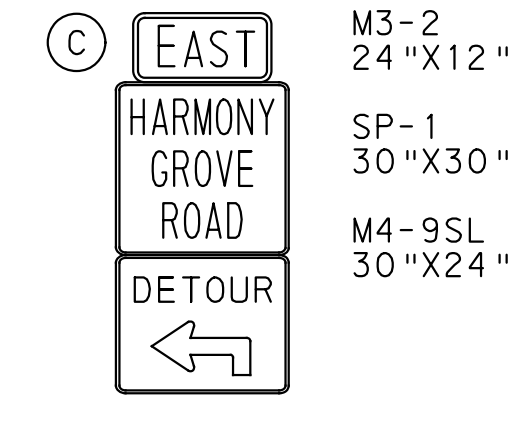

M3-2  
24"x12"  
SP-1  
30"x30"  
M4-9SL  
30"x24"

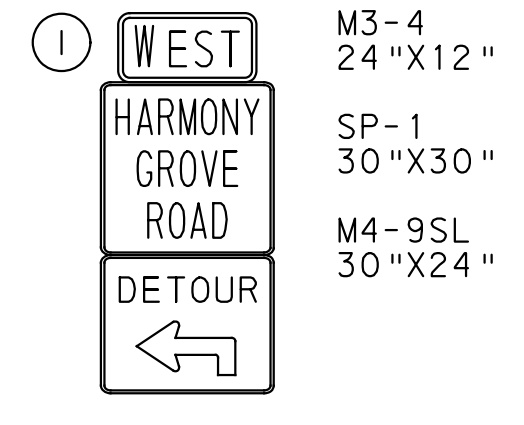

M3-4  
24"x12"  
SP-1  
30"x30"  
M4-9SL  
30"x24"

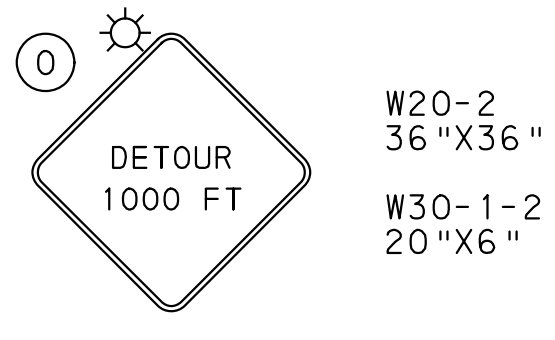

W20-2  
36"x36"  
W30-1-2  
20"x6"

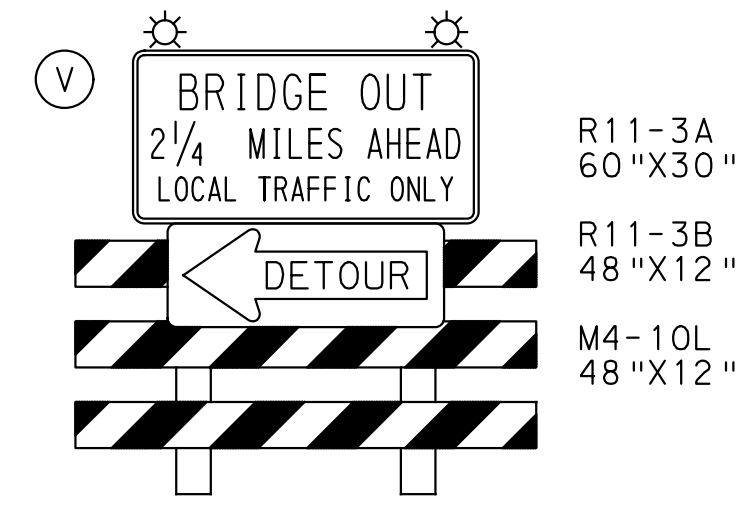

R11-3A  
60"x30"  
R11-3B  
48"x12"  
M4-10L  
48"x12"

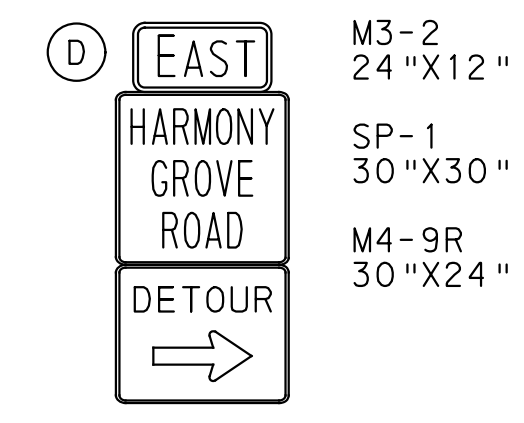

M3-2  
24"x12"  
SP-1  
30"x30"  
M4-9R  
30"x24"

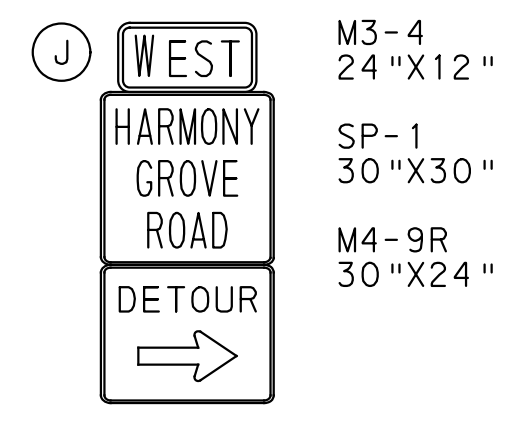

M3-4  
24"x12"  
SP-1  
30"x30"  
M4-9R  
30"x24"

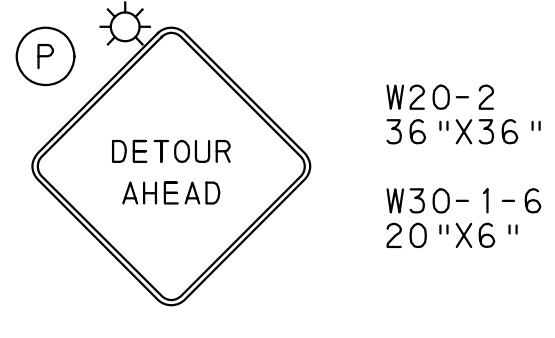

W20-2  
36"x36"  
W30-1-6  
20"x6"

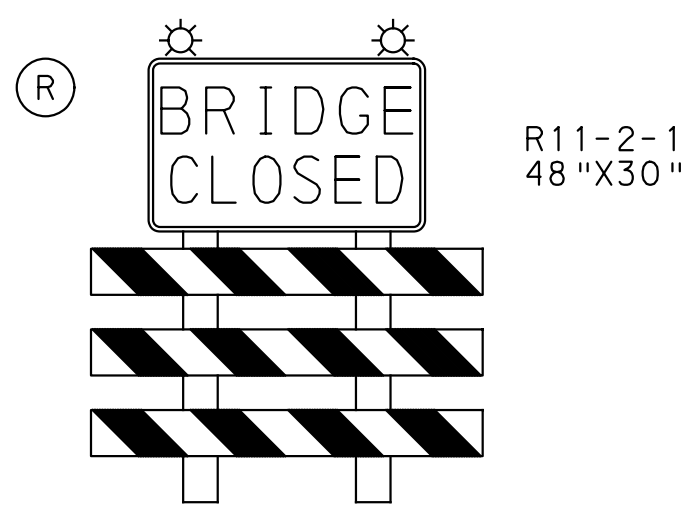

R11-2-1  
48"x30"

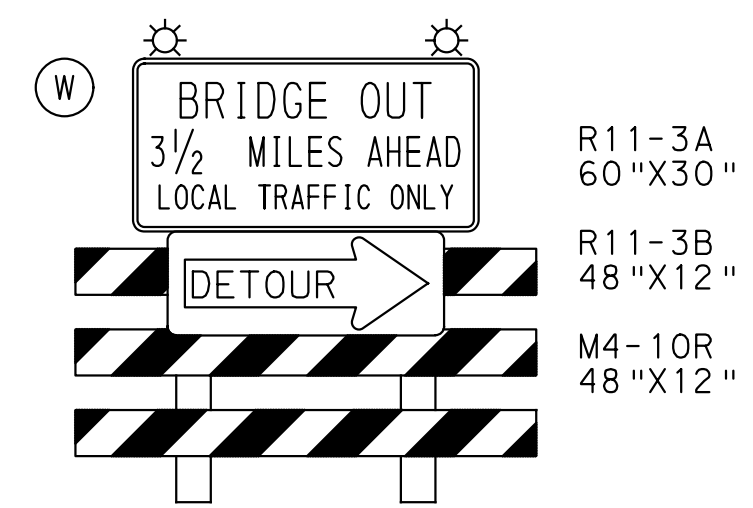

R11-3A  
60"x30"  
R11-3B  
48"x12"  
M4-10R  
48"x12"

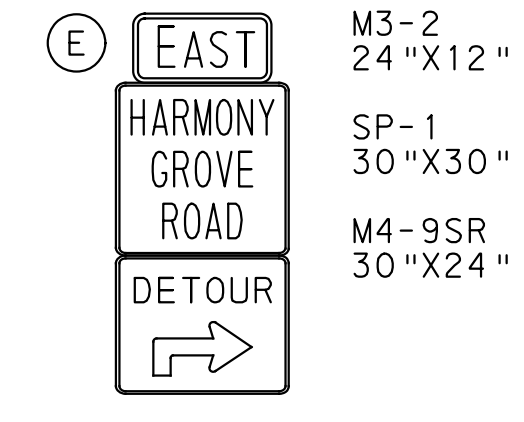

M3-2  
24"x12"  
SP-1  
30"x30"  
M4-9SR  
30"x24"

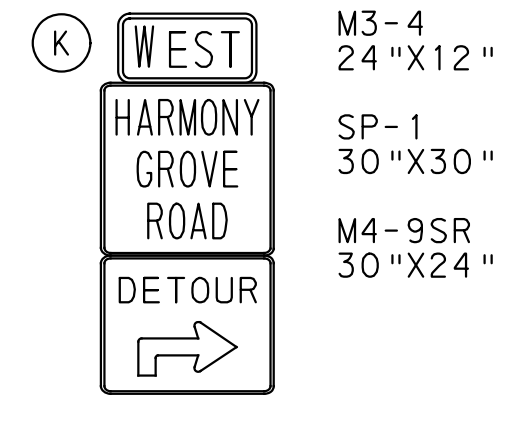

M3-4  
24"x12"  
SP-1  
30"x30"  
M4-9SR  
30"x24"

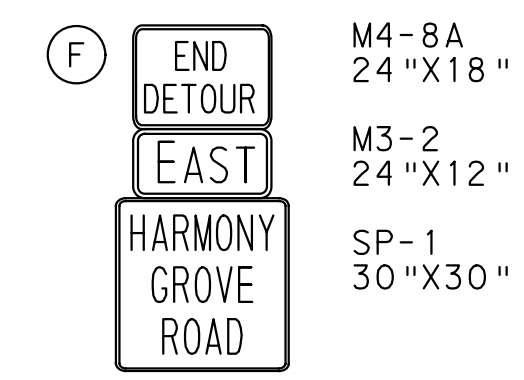

M4-8A  
24"x18"  
M3-2  
24"x12"  
SP-1  
30"x30"

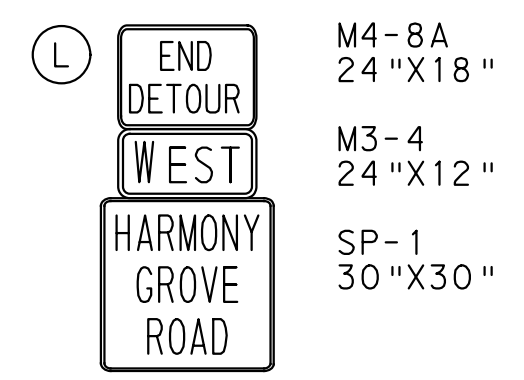

M4-8A  
24"x18"  
M3-4  
24"x12"  
SP-1  
30"x30"

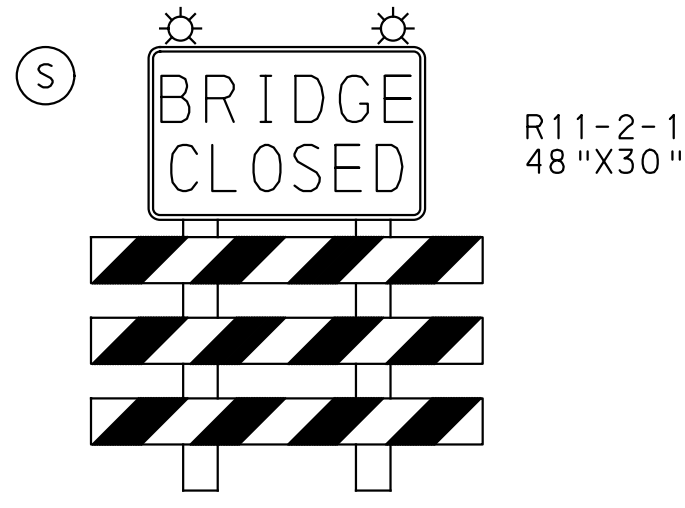

R11-2-1  
48"x30"

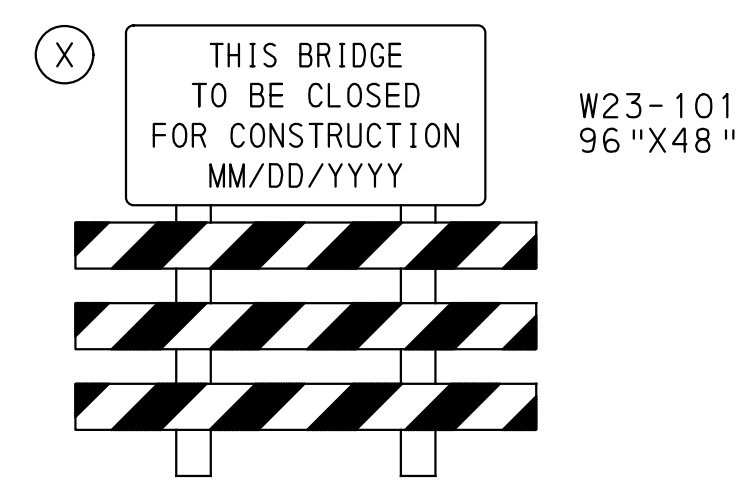

W23-101  
96"x48"

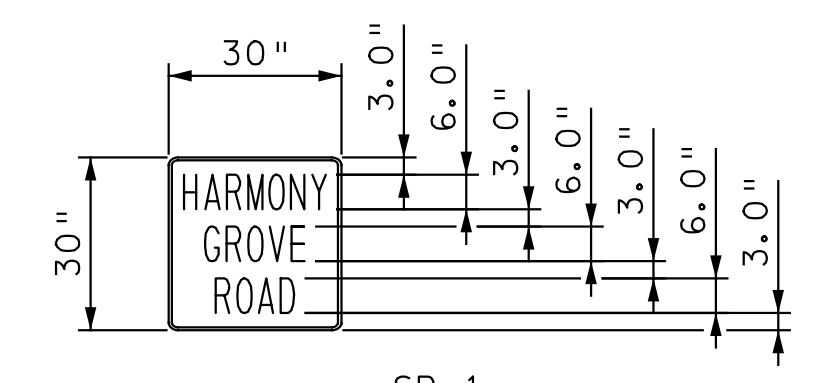

SP-1  
30" X 30"  
6" UPPERCASE SERIES B  
BLACK LEGEND AND BORDER  
ON ORANGE REFLECTORIZED BACKGROUND

* - 2.15	* - 6.65	* - 8.2
H - 3.4	G - 3.7	R - 3.4
A - 4.1	R - 3.4	O - 3.6
R - 3.7	O - 3.6	A - 4.1
M - 4.0	V - 3.7	D - 2.5
O - 3.9	E - 2.3	* - 8.2
N - 3.4	* - 6.65	TOTAL - 30.0
Y - 3.2	TOTAL - 30.0	
* - 2.15		
TOTAL - 30.0		

SIGN DETAIL  
TRAFFIC CONTROL PLAN

PRELIMINARY

2:50:58 PM 5/12/2023 s:\3085\SR 4014\CADD\R 7/03 PA P -0170 s:\3085\SR 4014\CADD\R 7/03 PA P -0170 s:\3085\SR 4014\CADD\R 7/03 PA P -0170